

July 25

EPIC

insulation and ufh systems

Product Catalogue

01923 725180

sales@epicinsulation.co.uk

EPIC Insulation offers installers guidance and options for any type of underfloor heating project.

Our wide range of UK manufactured products allows us to offer you exactly what you need.

Contents

Introduction	3
Profix®	4
Profix® Therm	7
Profix® Plus	9
Profoil® Lined XPS	12
Profoil® Sliced XPS	16
Progroove® XPS	19
Profoil® Lined EPS	25
Profoil® Sliced EPS	29
Profoil® Joist Lined EPS	33
Progroove® EPS	35
Progroove® Joist EPS	40
Protile®	43
Prochip	46
Prochip FF (Foiled)	49
Proplate	52
EPIC Edge Strips, Clip Rail	53
EPIC Overlay Boards, Adhesives	54



Designed & Manufacturing in the UK



insulation and ufh systems

EPIC Insulation rooted in heritage, building for the future

At EPIC Insulation, we know what matters to you – competitively priced, consistent quality products, a reliable supply, and a partner who delivers on time, every time.

Since its inception in 2011, EPIC Insulation has stood as a trusted name in the underfloor heating insulation industry. The original owner of the company, Graham Woolley, worked tirelessly to identify and produce solutions that met the evolving needs of the market. In 2020, Graham launched the market leading low profile, Profix® range of products. This quickly established itself as core to our range and customer requirements.

We have grown alongside our customers, merchants, contractors and installers, who rely on us for dependable products, expert advice and products that keep projects moving. Our reputation has been earned on site, in merchant branches and through long standing relationships built on trust.

Now under new ownership, EPIC Insulation is entering a bold new chapter. While our core values remain unchanged, we're investing in state-of-the-art enhanced manufacturing techniques, smarter logistics and a broader product range - so you get what you need, when you need it.



Why choose us?

- **Compliance and certification** – Products manufactured under ISO 9001 and ISO 14001 controls
- **Competitive pricing** – Strong supplier relationships and volume deals to help you stay profitable
- **Trade focussed service** – A dedicated technical and pricing support team who understand your business
- **Reliable stock and delivery** – Prompt flexible delivery options to keep your projects on schedule
- **Innovation driven** – Constantly evolving to bring you the latest in insulation technology and sustainability

This catalogue provides an insight to our core range, but we are more than just this. We have a flexible and fluid approach as we understand that no two projects are the same. If you do not see what you require, let us know and we will endeavour to help.

If you are new to EPIC Insulation or have been with us from the start, we invite you to join us on our journey, be part of the next chapter and experience the EPIC difference.

Warm Regards,

Richard Snudden, Brand Manager

Quick call



[epicinsulation.co.uk](https://www.epicinsulation.co.uk)

Made
from 100%
recycled plastic

Profix[®]

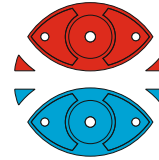

Low profile underfloor heating pipe retention panel

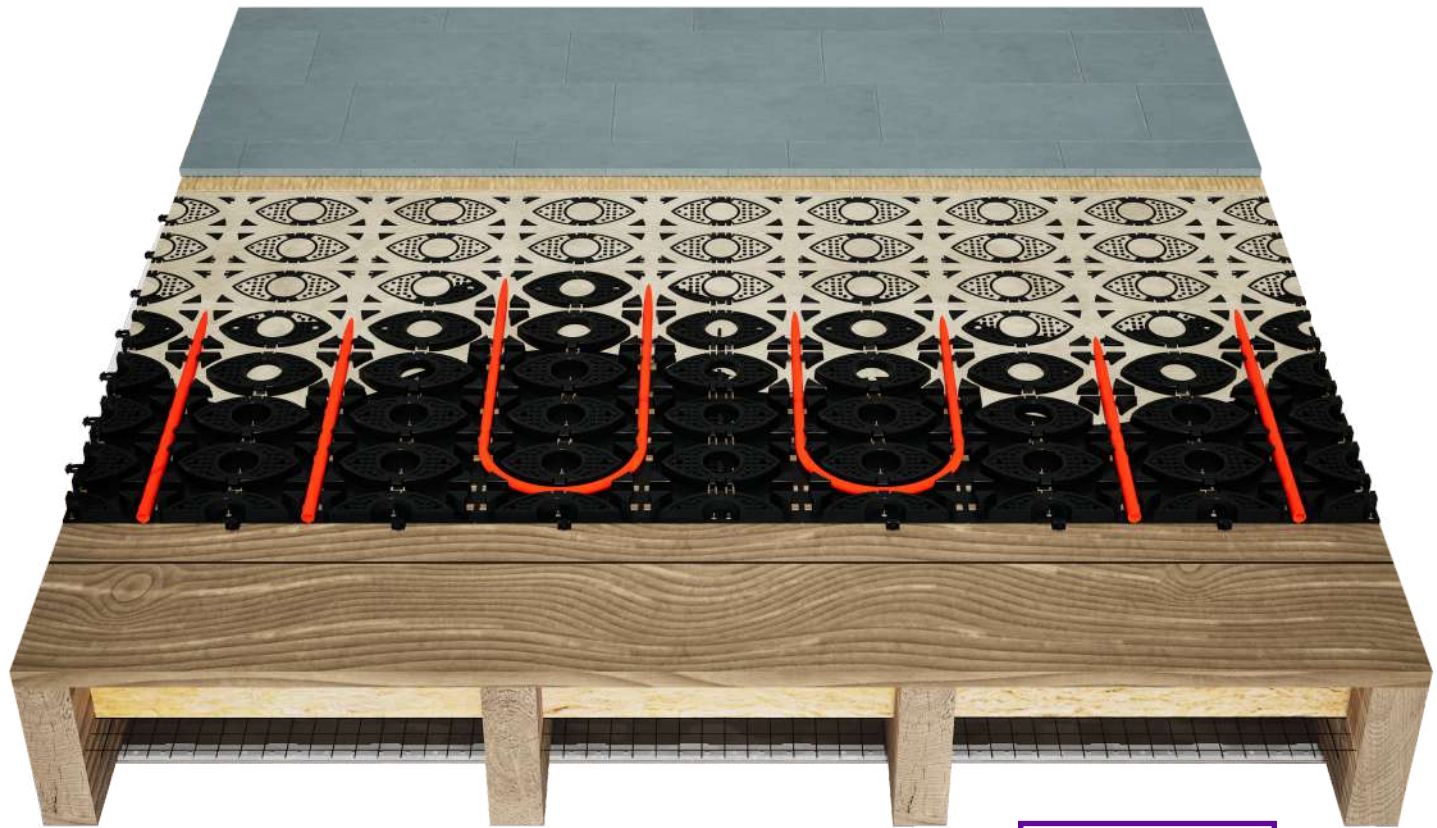

PATENTED

- Ultra low profile - Only 15mm deep
- Accepts 10 and 12mm diameter pipes
- Suitable for all types of concrete & timber floors
- Self adhesive backing
- High-impact plastic, easily cut to size
- Suitable for systems using thin self-levelling screed or under a dry-fit HiDECK board
- Rapid heating response



Designed & Manufactured in the UK



Profix[®]

Low profile, underfloor heating pipe retention panel

Technical specifications

Thickness - T	15mm
Panel size	600 x 600mm
Channel (to suit UFH pipe diameter) - D	10, 12mm
Pipe centre options - C	150, 300mm
Composition	100% recycled polypropylene
Associated highway strip	EPIC Highway Clip Rail
Associated polyethylene edge strip	EPIC Pro Edge

PATENTED

Order quantity

Panels per pack	10 (3.6m ²)
Packs per pallet	48
Min order qty	1 pack

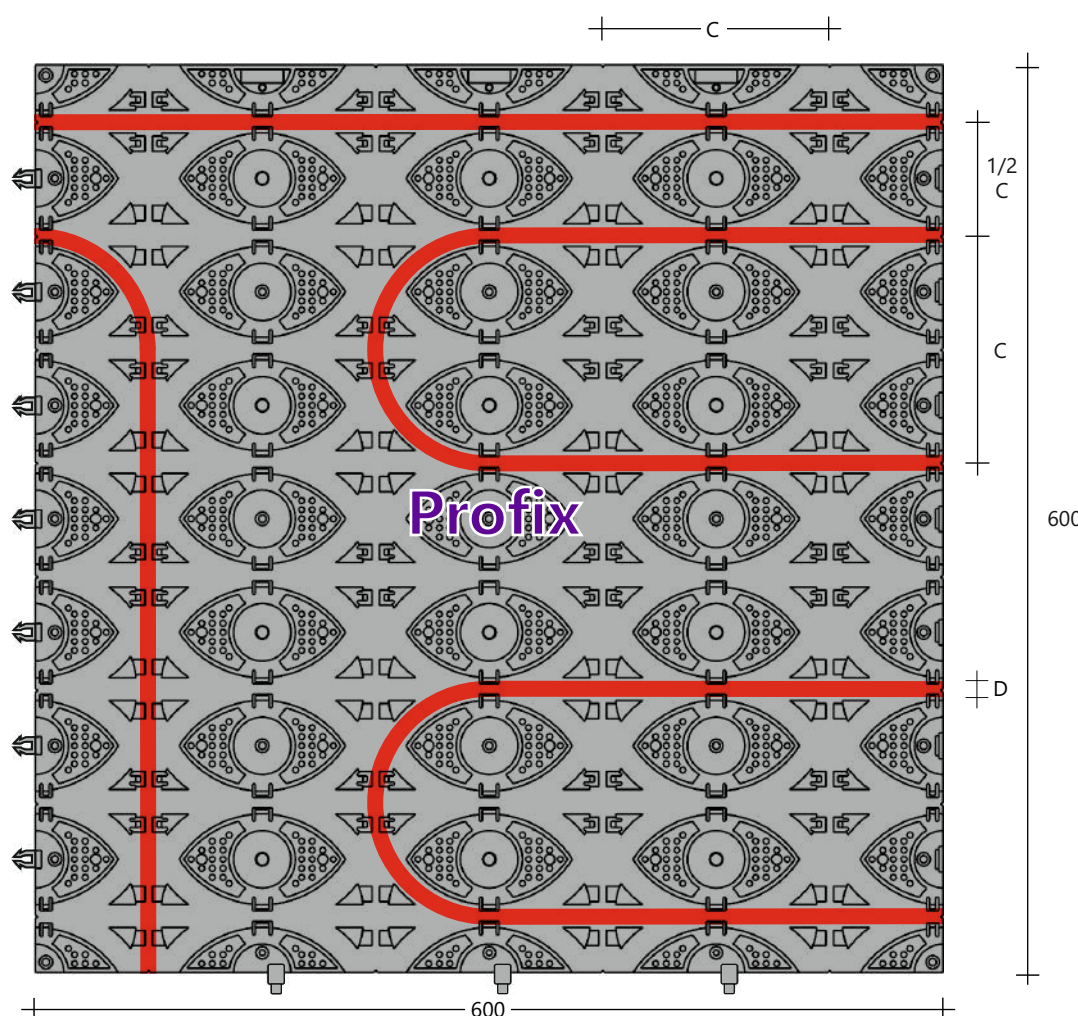
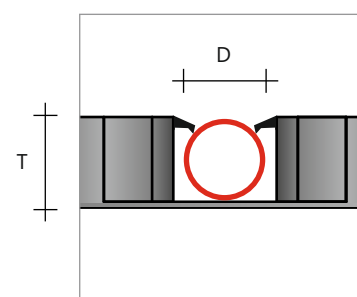

Associated accessories

EPIC Edge 75/AB Perimeter edge rolls



(P. 53)

EPIC Highway Clip Rail



(P. 53)

Colour of panel for illustration purposes only



Profix[®] Heat Output

Low profile, underfloor heating pipe retention panel + self-levelling screed

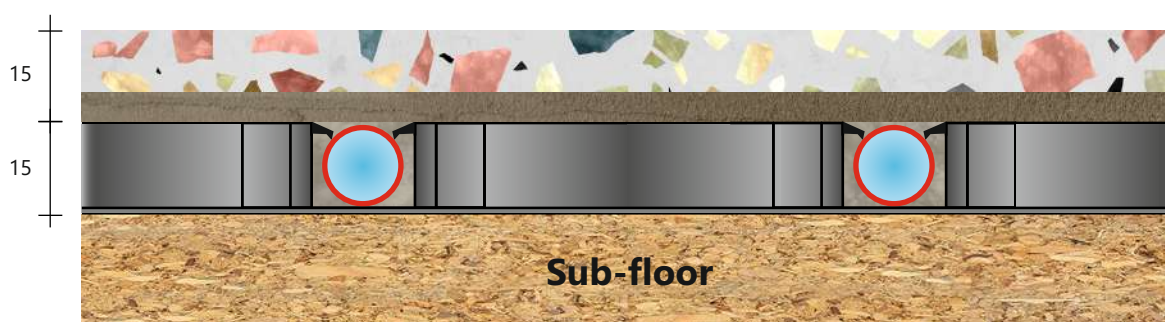

Floor covering	Mean water flow temperature									
	30°C		35°C		40°C		45°C		50°C	
	Output W/m ²	Surface temp °C	Output W/m ²	Surface temp °C	Output W/m ²	Surface temp °C	Output W/m ²	Surface temp °C	Output W/m ²	Surface temp °C
Ceramic tiles	56.6	25.2	84.9	27.8	113.2	30.4	141.5	33.1	169.9	35.7
Luxury vinyl tiles (LVT)	40.2	23.7	60.3	25.6	80.4	27.5	100.5	29.3	120.6	31.1
Engineered wood (15mm)	37.0	23.4	54.0	25.1	75.0	26.4	91.3	28.2	109.8	30.1
Carpet and underlay (1.5 TOG)	30.0	22.8	45.0	24.1	60.0	25.5	75	29.9	90.0	28.3

Notes

The heat outputs quoted were determined using computer modelled finite element analysis. Each system type was simulated using a floor surface heat transfer coefficient of 10.8W/m²K, with the surrounding air volume at 30°C in order to achieve steady state conditions. The thermal properties of each material were considered, including, but not limited to the thermal conductivity, specific heat capacity and density. The diameter of the underfloor heating pipework used was 12mm, with a wall thickness of 1.0mm, fixed at 150mm centres. The flow rate of the water within the pipework was maintained at 1.0m/s, combining both laminar and turbulent flow conditions. The internal temperature was regulated at five different temperatures, namely 30°C, 35°C, 40°C, 45°C and 50°C, throughout each test until steady state conditions were achieved through convergence of each individual parameter. The performance of a warm water underfloor heating system can be influenced by many factors and differences in actual heat output achieved on site may be observed when compared with the values stated. Therefore the heat output data shown is indicative and should be used for comparative purposes between systems and floor covering only.

Screed thickness

The thickness of levelling screed is dependent on the floor finish to be applied.

- Ceramic / porcelain floor tiles: 12mm (min) - up to the top of the Profix panel.
- Luxury vinyl tiles: 15mm (min) - 3-5mm above the Profix panel.
- Engineered wood: 15mm (min) - 3-5mm above the Profix panel.
- Carpet and underlay: 15mm (min) - 3-5mm above the Profix panel.

Profix[®] Therm X

Low profile underfloor heating pipe retention panel with integral thermal insulation barrier

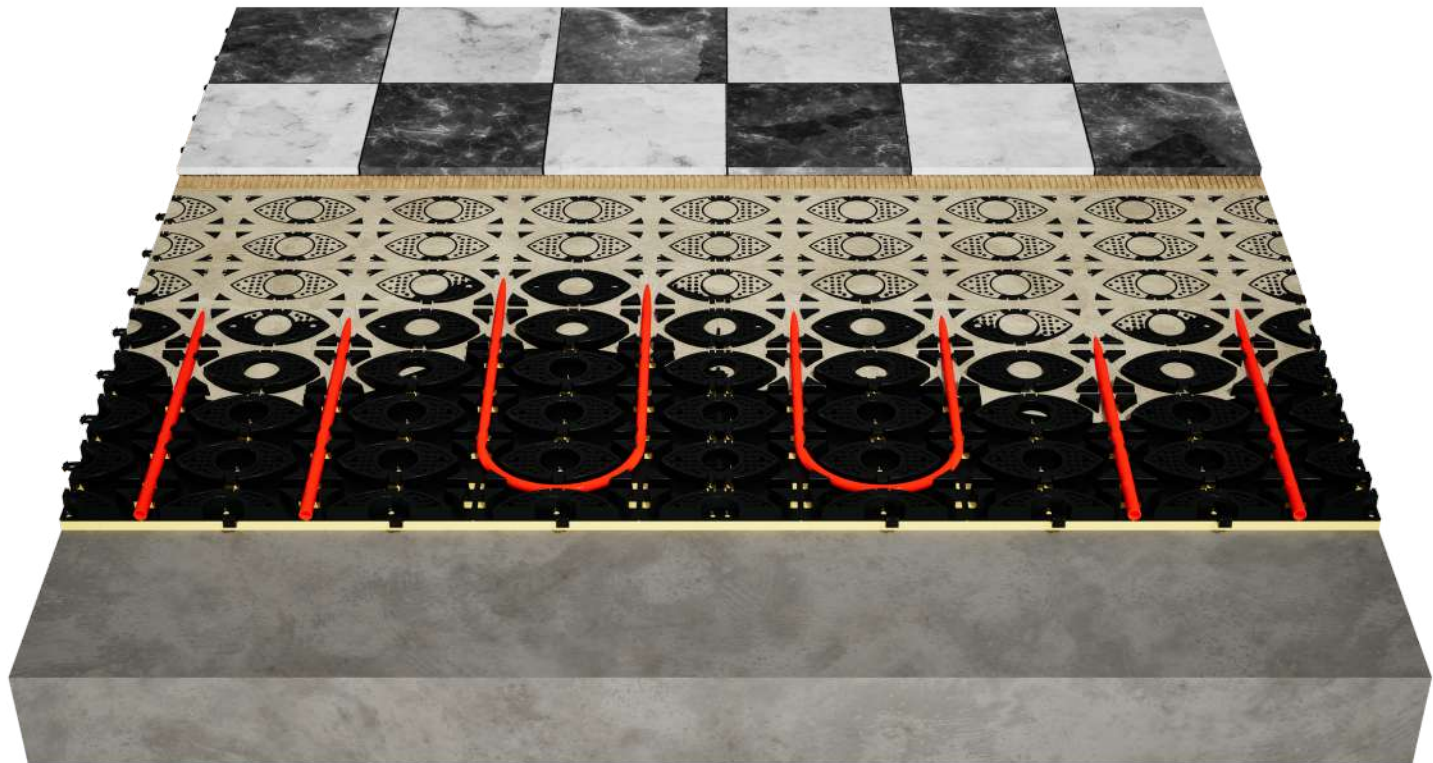

PATENTED

- Ultra low profile, as thin as 18mm deep
- Three pre-bonded insulation barrier thickness' available (3, 6, 10mm)
- Accepts 10 and 12mm diameter pipes
- Suitable for all types of concrete & timber floors
- High-impact plastic, easily cut to size
- Suitable for systems using thin self-levelling screed or under a dry-fit HiDECK board
- Rapid heating response



Designed & Manufactured in the UK

Made from 100%
recycled
plastic

epicinsulation.co.uk



Profix[®] Therm X

Low profile, underfloor heating pipe retention panel with integral thermal barrier

Technical specifications

Thickness	15mm (T1) + 3, 6 or 10mm XPS (T2)
Panel size	600 x 600mm
Channel (to suit UFH pipe diameter) - D	10, 12mm
Pipe centre options - C	150, 300mm
Composition	100% recycled polypropylene
Thermal insulation	300kPa XPS (extruded polystyrene)
Thermal resistance of XPS T2 (m ² K/W)	3 = 0.091, 6 = 0.182, 10 = 0.303
Associated polyethylene edge strip	EPIC Pro Edge

PATENTED

Order quantity

Coverage per panel	0.36m ²
Min order qty	1 panel

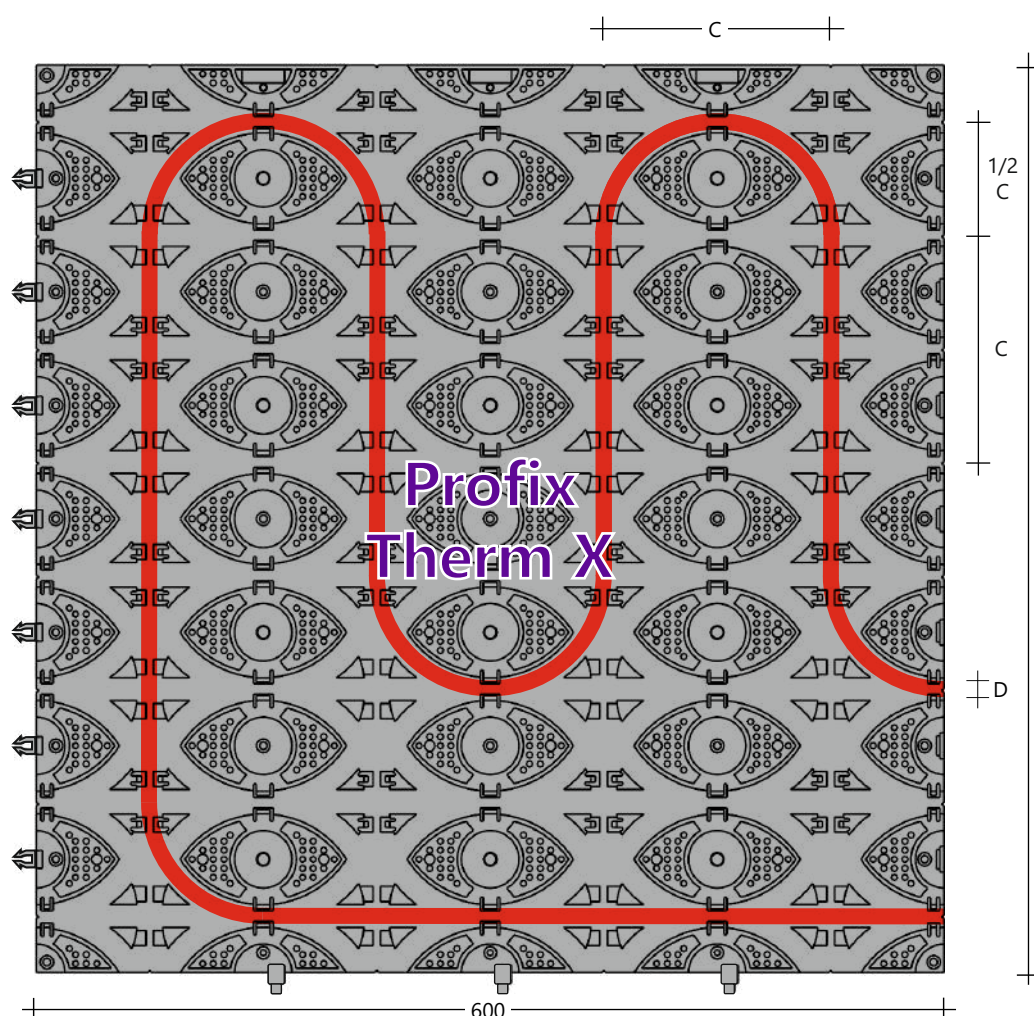
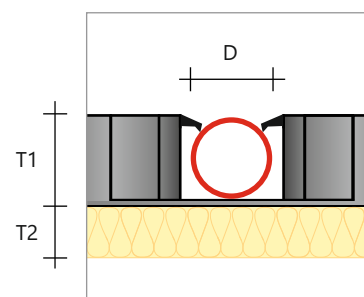

Associated accessories

EPIC Edge 75/AB
Perimeter edge rolls



(P. 53)

EPIC Highway
clip rail



(P. 53)

Colour of panel for illustration purposes only

Made
from 100%
recycled plastic

Profix[®] Plus

Low profile underfloor heating pipe retention panel

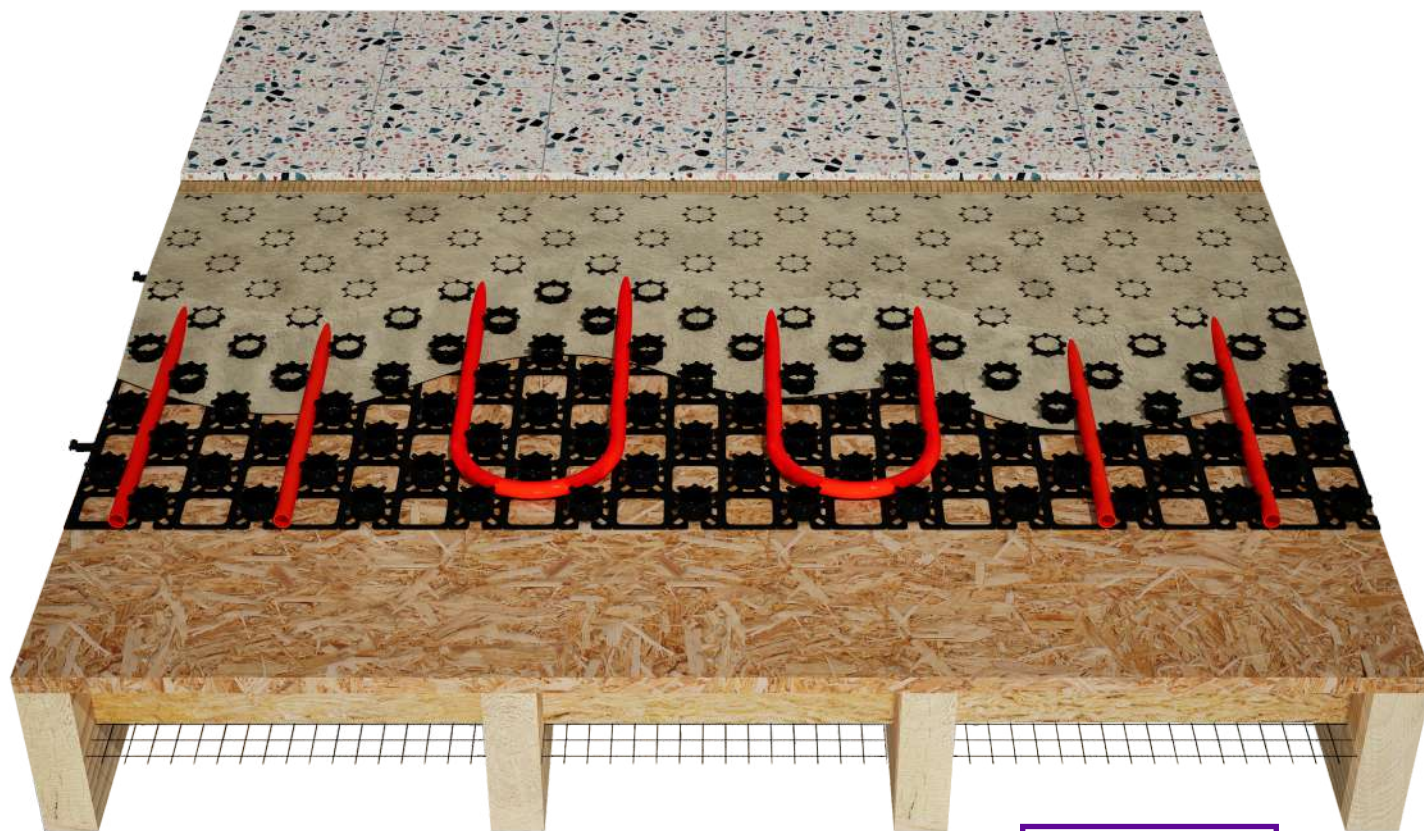

PATENTED

- Low profile - Only 20mm deep
- Accepts 14 - 17mm diameter pipes
- Suitable for all types of concrete & timber floors
- Self adhesive backing
- High-impact plastic, easily cut to size
- Suitable for systems using thin self-levelling screed or under a dry-fit HiDECK board
- Rapid heating response



Designed & Manufactured in the UK

epicinsulation.co.uk



Profix[®] Plus

Low profile, underfloor heating pipe retention panel

PATENTED

Technical specifications

Thickness - T	20mm
Panel size	600 x 1200mm
Clamp width (to suit UFH pipe diameter) - D	14, 15, 16, 17mm
Pipe centre options - C	150, 200, 300mm
Composition	100% recycled polypropylene
Associated polyethylene edge strip	EPIC Pro Edge

Order quantity

Coverage per panel	0.72m ²
Min order qty	1 panel

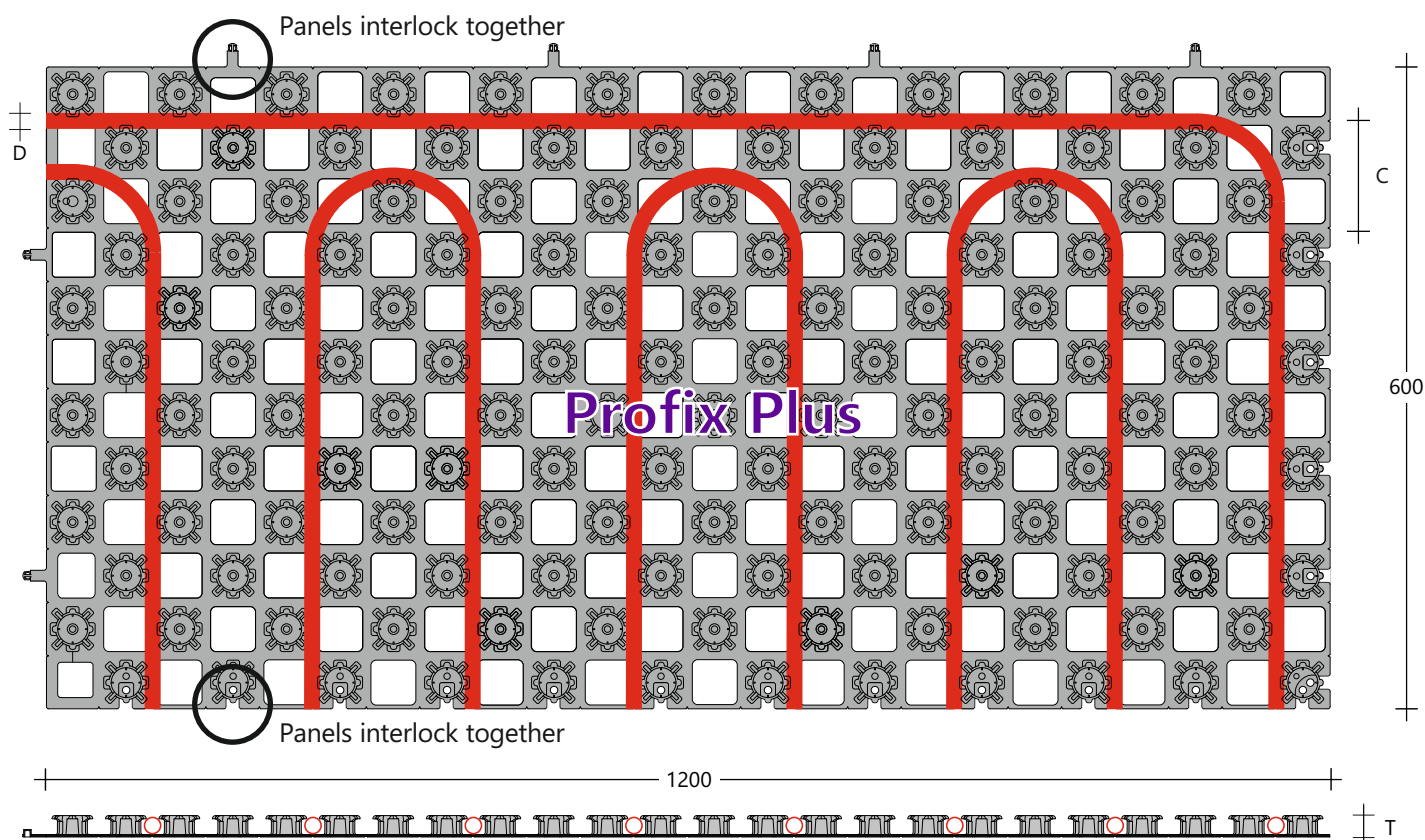
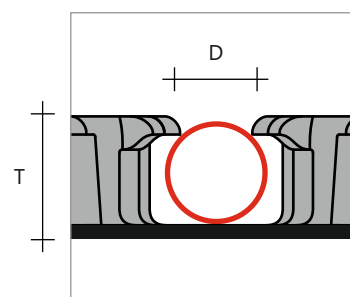

Colour of panel for illustration purposes only

Profoil[®] XPS

Foil faced high compressive strength XPS underfloor heating board

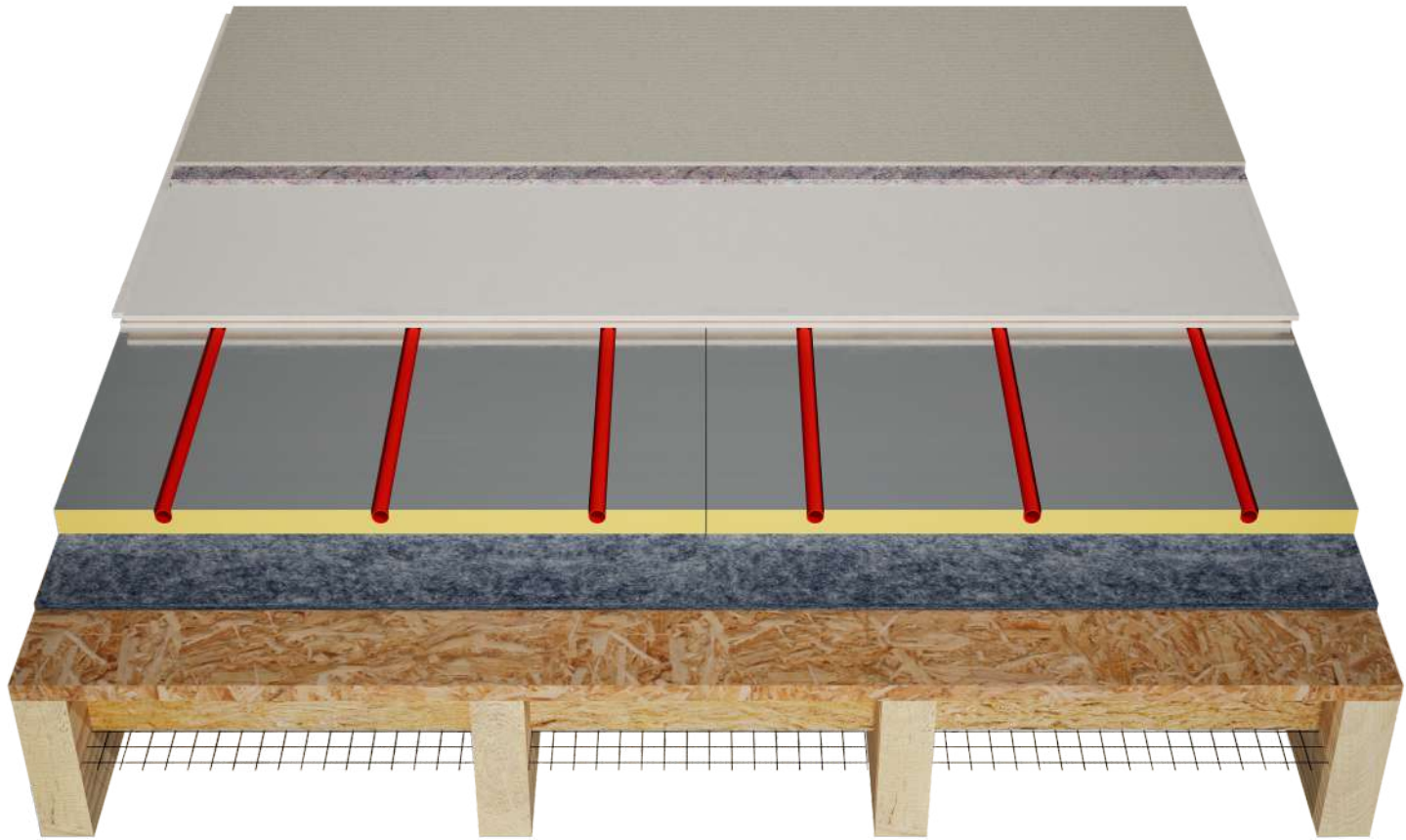

- Offered in three grades of high compressive strength XPS (300, 400 & 500kPa)
- Faced with 100 micron aluminum foil for effective heat diffusion
- Wide range of thickness' available
- Two route patterns offered
- Suitable for all types of concrete & timber floors
- Quick and easy to install
- Excellent thermal performance



Designed & Manufactured in the UK



Profoil® Lined XPS 300

Foil faced and channels lined, high compressive strength XPS underfloor heating board

Technical specifications

Thickness' available - T	20, 25, 30mm ⁽¹⁾
Board size	600 x 1250mm
Route size (to suit UFH pipe diameter) - D	10, 12, 14, 15, 16mm
Pipe centre options	150, 200, 300mm
Thickness of aluminium foil facing	100µm (with channels fully lined)
Route patterns	Radius, Bulb, Highway ⁽²⁾
Strength at 10% compression (EN 826)	300kPa
Thermal conductivity (EN 12667)	0.033W/mK
Associated polyethylene edge strip	EPIC Pro Edge

(1) Other thickness' manufactured to order, subject to minimum quantity.

(2) Other patterns manufactured to order, subject to minimum quantity.

Order quantity

Boards per pack	N/A
Min order qty	1 board

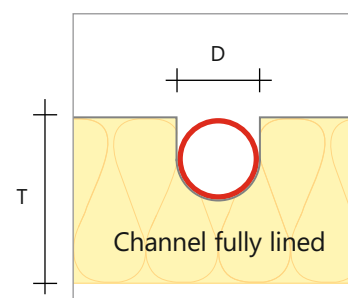

Profoil® Lined XPS 400

Foil faced and channels lined, ultra high compressive strength extruded polystyrene underfloor heating board

Technical specifications

Thickness' available - T	18, 20, 25*mm ⁽¹⁾
Board sizes	600 x 1200, 600 x 1250*mm
Route size (to suit UFH pipe diameter) - D	10, 12, 14, 15 ⁽²⁾ , 16 ⁽²⁾ mm
Pipe centre options	150, 200, 300mm
Thickness of aluminium foil facing	100µm (with channels fully lined)
Route patterns	Radius, Bulb, Highway ⁽³⁾
Strength at 10% compression (EN 826)	400kPa
Thermal conductivity (EN 12667)	0.035W/mK
Associated polyethylene edge strip	EPIC Pro Edge

(1) Other thickness' manufactured to order, subject to minimum quantity.

(2) Not available in 18mm thick boards.

(3) Other patterns manufactured to order, subject to minimum quantity

Order quantity

Boards per pack	N/A
Min order qty	1 board

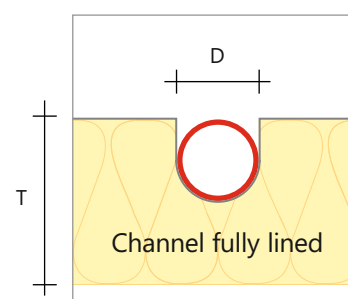



Profoil® Lined XPS 500

Foil faced and channels lined ultra high compressive strength XPS underfloor heating board

Technical specifications

Thickness' available - T	15mm ⁽¹⁾
Board size	600 x 1200
Route size (to suit UFH pipe diameter) - D	10mm
Pipe centre options - C	150, 200, 300mm
Thickness of aluminium foil facing	100µm (with channels fully lined)
Route patterns	Radius, Bulb, Highway ⁽²⁾
Strength at 10% compression (EN 826)	500kPa
Thermal conductivity (EN 12667)	0.035W/mK
Associated polyethylene edge strip	EPIC Pro Edge

(1) Other thickness' manufactured to order, subject to minimum quantity.

(2) Other patterns manufactured to order, subject to minimum quantity.

Order quantity

Boards per pack	N/A
Min order qty	1 board

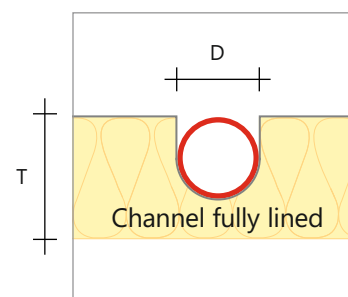



Profoil® Lined XPS Channel Patterns

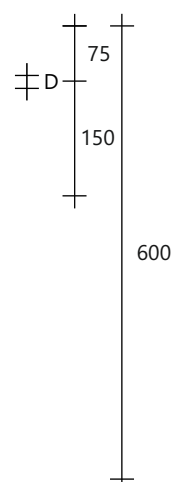
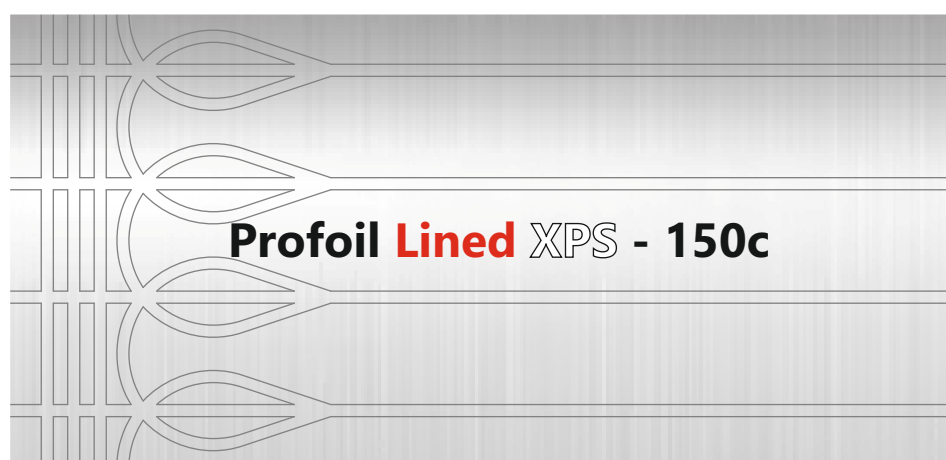

Bulb

150c also available
in Radius pattern

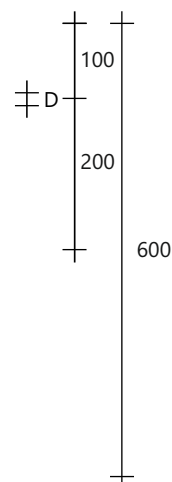
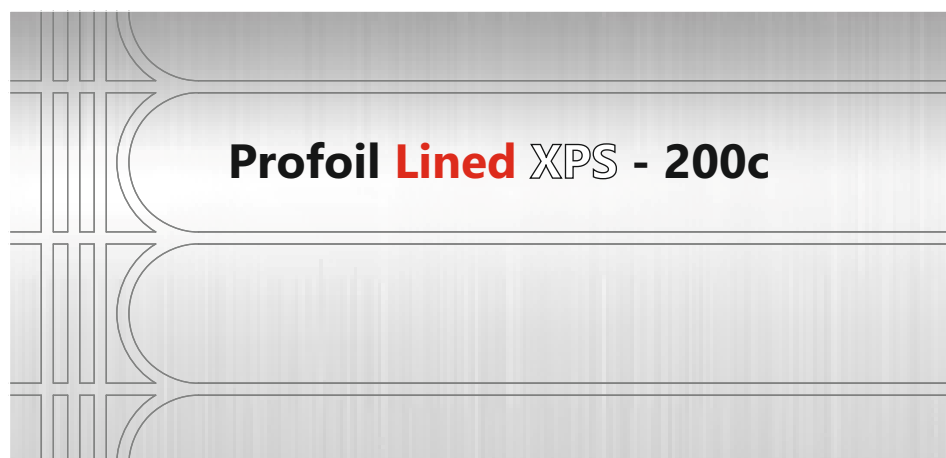

Radius

200c also available
in Bulb pattern

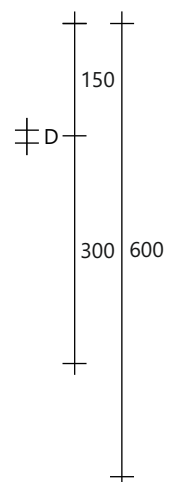

Bulb

300c also available
in Radius pattern



Profoil® Lined XPS Channel Patterns

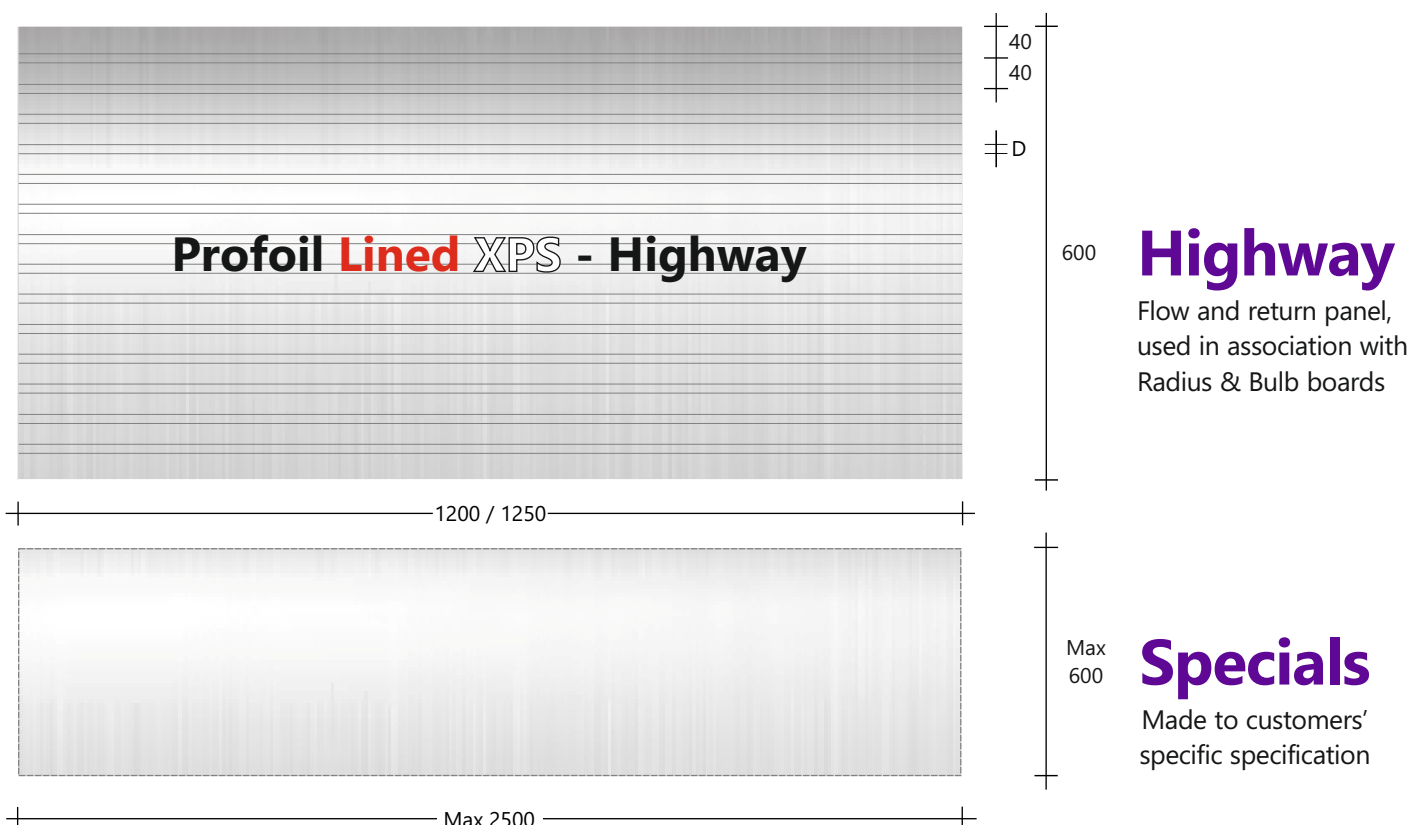

Associated accessories





Profoil® Sliced XPS 300

Foil faced high compressive strength extruded polystyrene underfloor heating board

Technical specifications

Thickness' available - T	20, 25, 30mm ⁽¹⁾
Board size	600 x 1250
Route size (to suit UFH pipe diameter) - D	10, 12, 14, 15, 16mm
Pipe centre options	150, 200, 300mm
Thickness of aluminium foil facing	100, 200 ⁽²⁾ µm (with foil pre-sliced)
Route patterns	Radius, Bulb, Highway ⁽³⁾
Strength at 10% compression (EN 826)	300kPa
Thermal conductivity (EN 12667)	0.033W/mK
Associated polyethylene edge strip	EPIC Pro Edge

(1) Other thickness' manufactured to order, subject to minimum quantity. (2) Manufactured to order, subject to minimum quantity.
(3) Other patterns manufactured to order, subject to minimum quantity.

Order quantity

Boards per pack	N/A
Min order qty	1 board

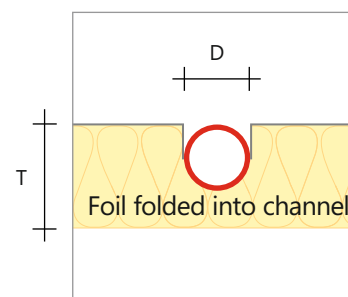

Associated accessories





The image displays three technical drawings of Profoil Sliced XPS insulation boards, each showing a cross-section and a detail view of the foil profile.

- Profoil Sliced XPS - 150c:** The cross-section shows a board with a thickness of 150mm. The detail view shows a foil profile with a radius of 75mm. The board is 1250mm wide.
- Profoil Sliced XPS - 200c:** The cross-section shows a board with a thickness of 200mm. The detail view shows a foil profile with a radius of 100mm. The board is 1250mm wide.
- Profoil Sliced XPS - 300c:** The cross-section shows a board with a thickness of 300mm. The detail view shows a foil profile with a bulb of 150mm. The board is 1250mm wide.

Each drawing includes a dimension line indicating the width of the board (1250mm) and a dimension line indicating the thickness of the board (150mm, 200mm, or 300mm). The detail view shows the foil profile with a radius or bulb dimension.



Profoil® Sliced XPS Channel Patterns

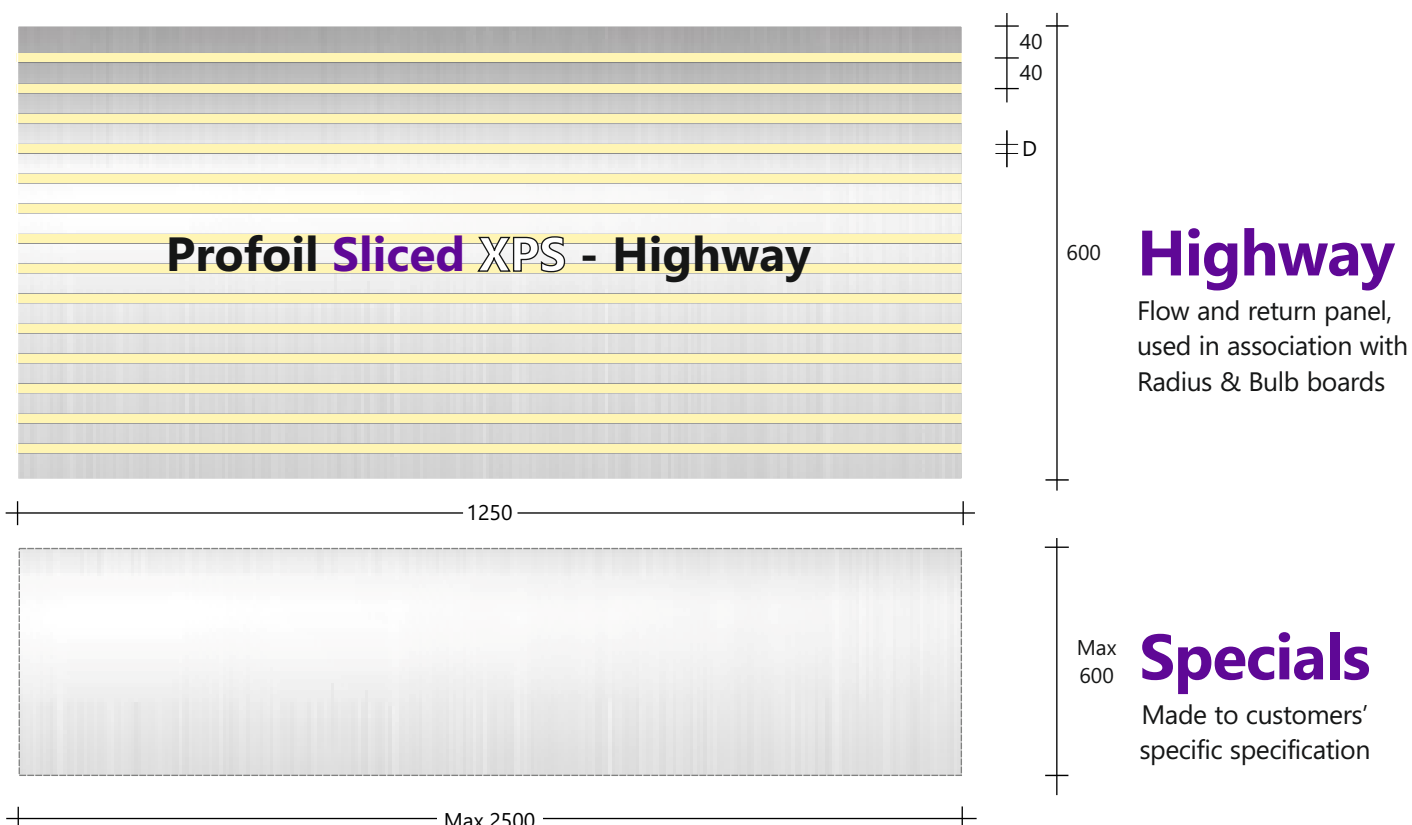

Progroove[®] XPS

Foil faced high compressive strength XPS underfloor heating board



- Offered in three high compressive strength grades: 300, 400 & 500kPa
- Works in conjunction with EPIC Proplates to deliver outstanding heat diffusion
- Wide range of thickness' available
- Two channel patterns offered
- Suitable for all types of concrete & timber floors
- Quick and easy to install
- Excellent thermal performance



Designed & Manufactured in the UK



Progroove® XPS 300

High compressive strength grooved extruded polystyrene underfloor heating board

Technical specifications

Thickness' available - T	20, 25, 30mm ⁽¹⁾
Board sizes	600 x 1250, 600 x 2500mm
Route size (to suit UFH pipe diameter) - D	10, 12, 14, 15, 16mm
Pipe centre options - C	150, 200, 300mm
Route patterns	Radius, Bulb, Highway ⁽²⁾
Strength at 10% compression (EN 826)	300kPa
Thermal conductivity (EN 12667)	0.033 W/mK
Associated aluminium heat diffuser	EPIC Proplate - Single
Associated polyethylene edge strip	EPIC Pro Edge

(1) Other thickness' manufactured to order, subject to minimum quantity.

(2) Other patterns manufactured to order, subject to minimum quantity.

Order quantity

Boards per pack	N/A
Min order qty	1 board

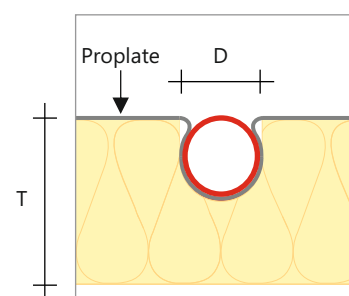

Note. EPIC Proplate sold separately

Progroove® XPS 400

Ultra high compressive strength grooved extruded polystyrene underfloor heating board

Technical specifications

Thickness' available - T	18, 20, 25*mm ⁽¹⁾
Board sizes	600 x 1200, 600 x 1250*mm
Route size (to suit UFH pipe diameter) - D	10, 12, 14, 15 ⁽²⁾ , 16 ⁽²⁾ mm
Pipe centre options - C	150, 200, 300mm
Route patterns	Radius, Bulb, Highway ⁽³⁾
Strength at 10% compression (EN 826)	400kPa
Thermal conductivity (EN 12667)	0.035 W/mK
Associated aluminium heat diffuser	Proplate - Single
Associated polyethylene edge strip	Epic Pro Edge

(1) Other thickness' manufactured to order, subject to minimum quantity. (2) Not available in 18mm thick boards.

(3) Other patterns manufactured to order, subject to minimum quantity.

Order quantity

Boards per pack	N/A
Min order qty	1 board

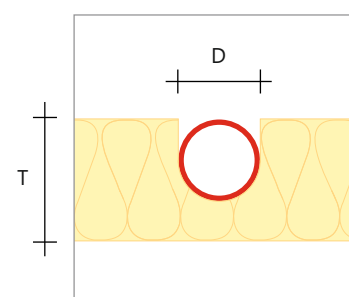

Note. EPIC Proplate required



Progroove[®] XPS 500

Ultra high compressive strength grooved extruded polystyrene underfloor heating board

Technical specifications

Thickness' available - T	15mm ⁽¹⁾
Board sizes	600 x 1200
Route size (to suit UFH pipe diameter) - D	10mm
Pipe centre options - C	150, 200, 300mm
Route patterns	Radius, Bulb, Highway ⁽²⁾
Strength at 10% compression (EN 826)	500kPa
Thermal conductivity (EN 12667)	0.035 W/mK
Associated aluminium heat diffuser	EPIC Proplate - Single
Associated polyethylene edge strip	EPIC Pro Edge

(1) Other thickness' (40 - 100mm) manufactured to order, subject to minimum quantity.

(2) Other patterns manufactured to order, subject to minimum quantity.

Order quantity

Boards per pack	N/A
Min order qty	1 board

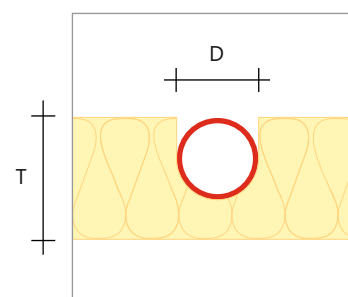

Note. EPIC Proplate required

Associated accessories

EPIC Proplate Single

Aluminium heat diffuser



(P. 52)

EPIC Edge 75/AB

Self-adhesive perimeter edge roll



(P. 53)

HiDECK Overlay 18

Highly conductive floorboard



(P.54)



Progroove[®] XPS Channel Patterns

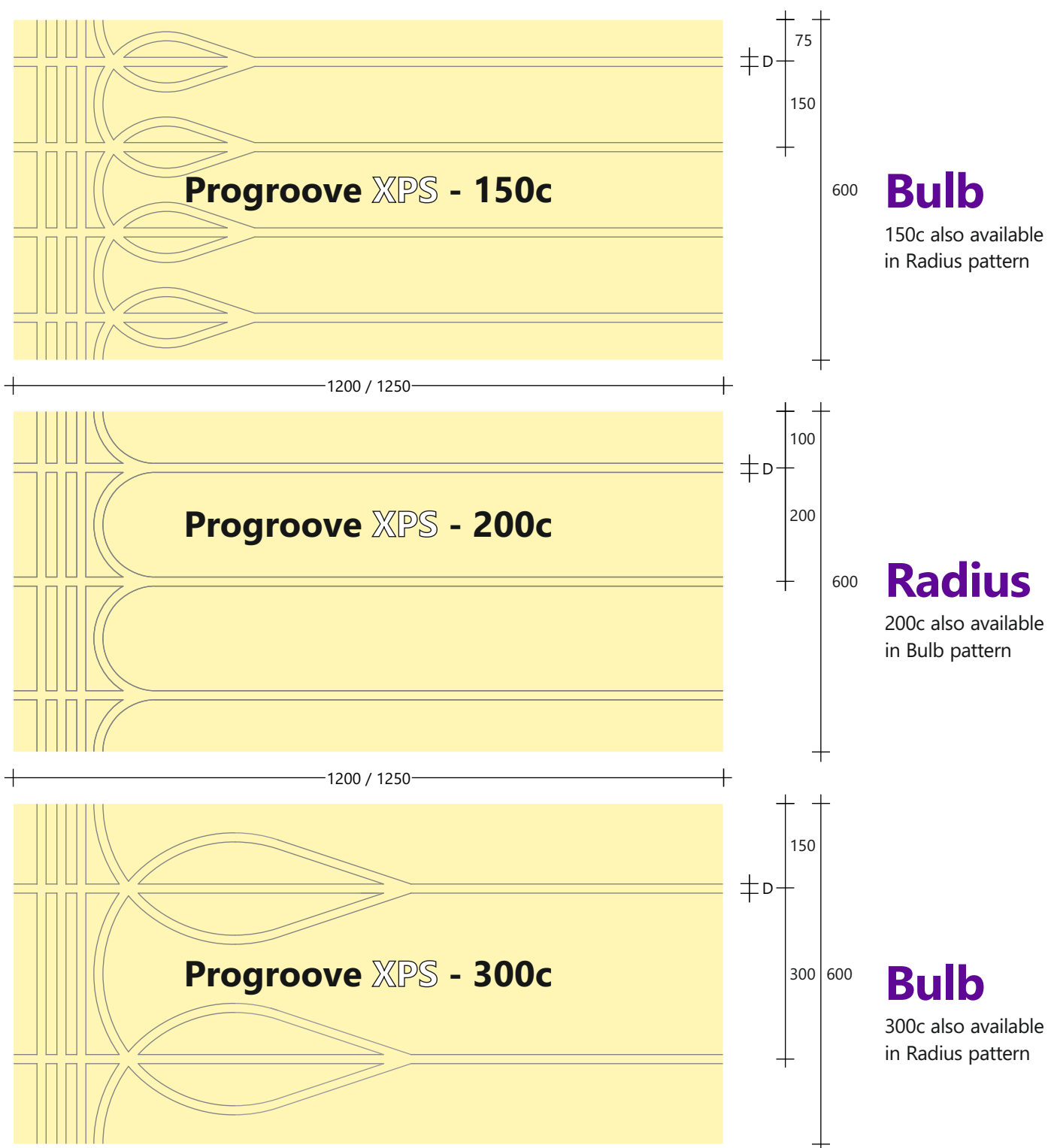



Progroove[®] XPS Channel Patterns

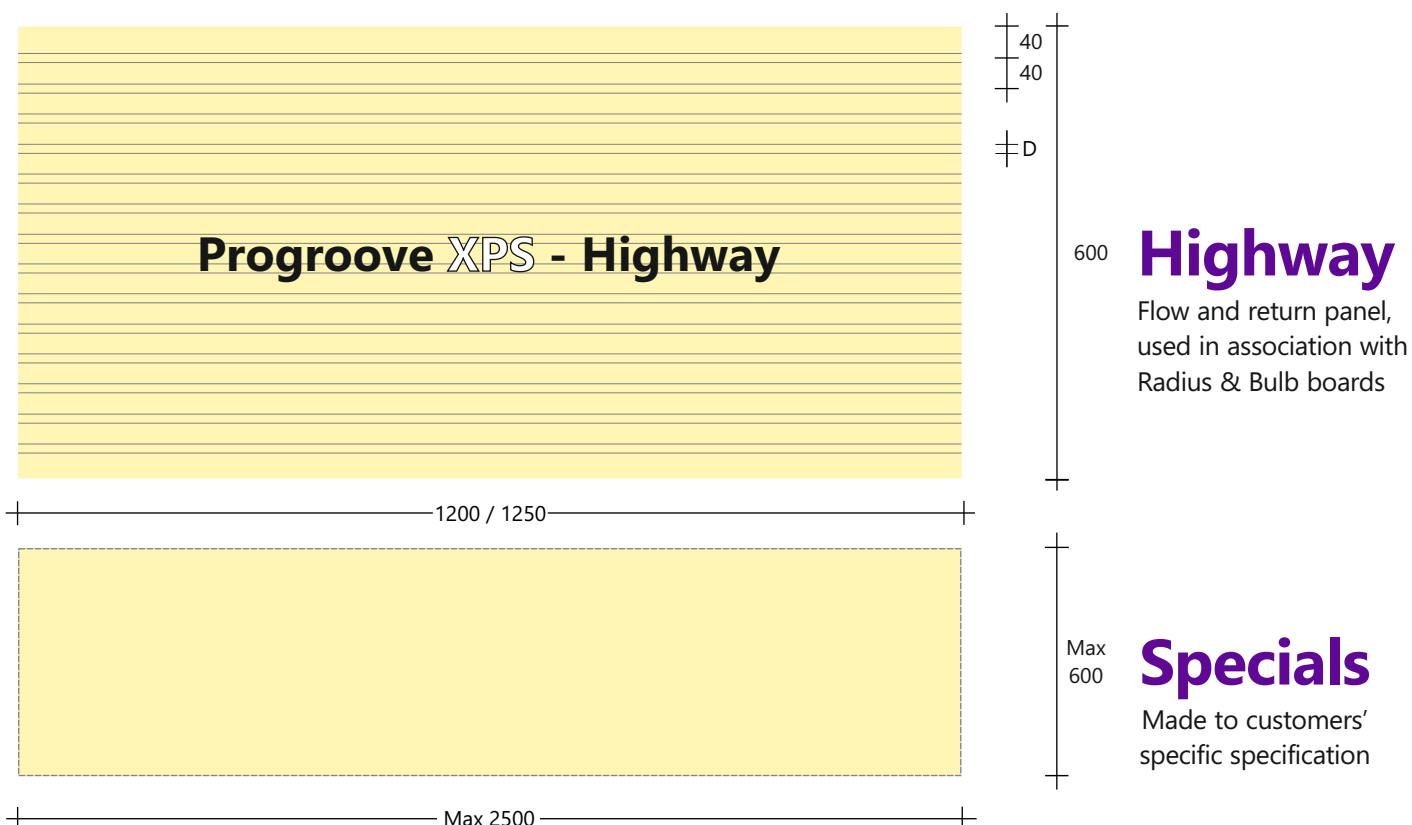

Profoil[®] EPS

Foil faced expanded polystyrene underfloor heating board



- Offered in two grades of expanded polystyrene (100 & 200kPa)
- Faced with 100 micron aluminum foil for effective heat diffusion
- Wide range of thickness' available
- Two channel patterns offered
- Suitable for all types of concrete & timber floors
- Quick and easy to install
- Excellent thermal performance



Designed & Manufactured in the UK



Profoil® Lined EPS 100

Foil faced and channels lined expanded polystyrene underfloor heating board

Technical specifications

Thickness' available - T	20, 25, 30, 40, 50, 60, 75mm ⁽¹⁾
Board sizes	600 x 1200mm & 1200 x 1200mm
Channel size (to suit UFH pipe diameter) - D	10, 12, 14 ⁽²⁾ , 15 ⁽²⁾ , 16 ⁽²⁾ mm
Pipe centre options	150, 200, 300mm
Thickness of aluminium foil facing	100µm (with channels fully lined)
Route patterns	Radius, Bulb, Highway, ⁽³⁾
Strength at 10% compression (EN 826)	100kPa ⁽⁴⁾
Thermal conductivity (EN 13163)	0.036 W/mK
Associated polyethylene edge strip	EPIC Pro Edge

(1) Other thickness' manufactured to order, subject to minimum quantity. (2) Not available in 20mm thick boards.

(3) Other patterns manufactured to order, subject to minimum quantity. (4) 150 & 400kPa manufactured to order, subject to quantity.

Order quantity

Boards per pack	N/A
Min order qty	1 board

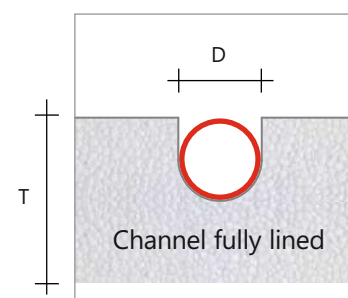

Profoil® Lined EPS 200

Foil faced and channels lined expanded polystyrene underfloor heating board

Technical specifications

Thickness' available - T	18, 25, 28, 30,mm ⁽¹⁾
Board sizes	600 x 1200mm & 1200 x 1200mm
Channel size (to suit UFH pipe diameter) - D	10, 12, 14 ⁽²⁾ , 15 ⁽²⁾ , 16 ⁽²⁾ mm
Pipe centre options	150, 200, 300mm
Thickness of aluminium foil facing	100µm (with channels fully lined)
Route patterns	Radius, Bulb, Highway ⁽³⁾
Strength at 10% compression (EN 826)	200kPa
Thermal conductivity (EN 13163)	0.034 W/mK
Associated polyethylene edge strip	Epic Pro Edge

(1) Other thickness' manufactured to order, subject to minimum quantity. (2) Not available in 18mm thick boards.

(3) Other patterns manufactured to order, subject to minimum quantity.

Order quantity

Boards per pack	N/A
Min order qty	1 board

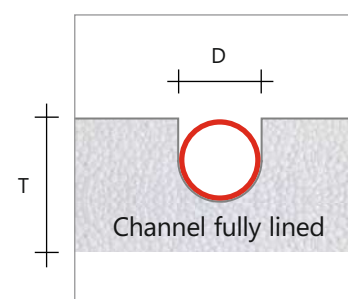



Profoil® Lined EPS Channel Patterns

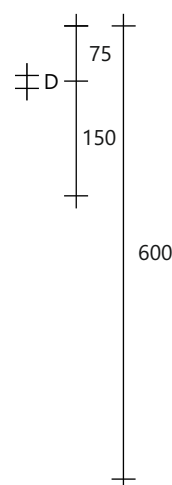
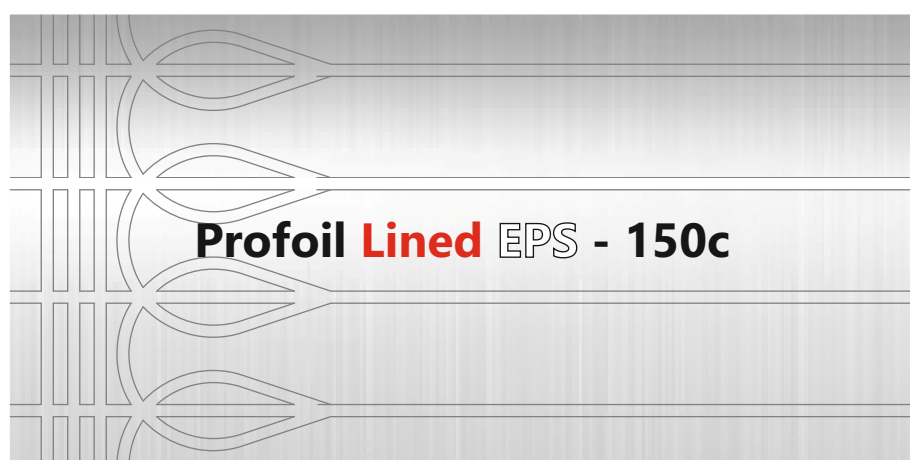

Bulb

150c also available
in Radius pattern

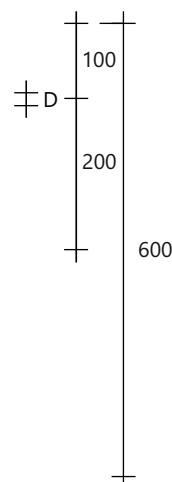
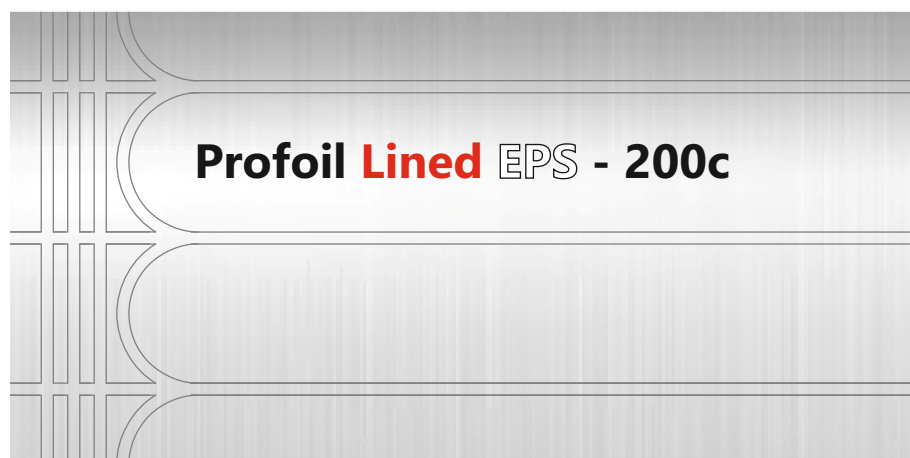

Radius

200c also available
in Bulb pattern

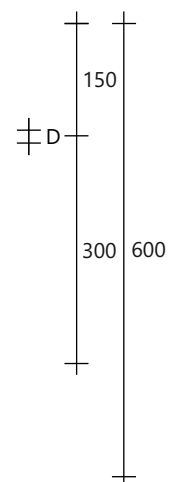

Bulb

300c also available
in Radius pattern

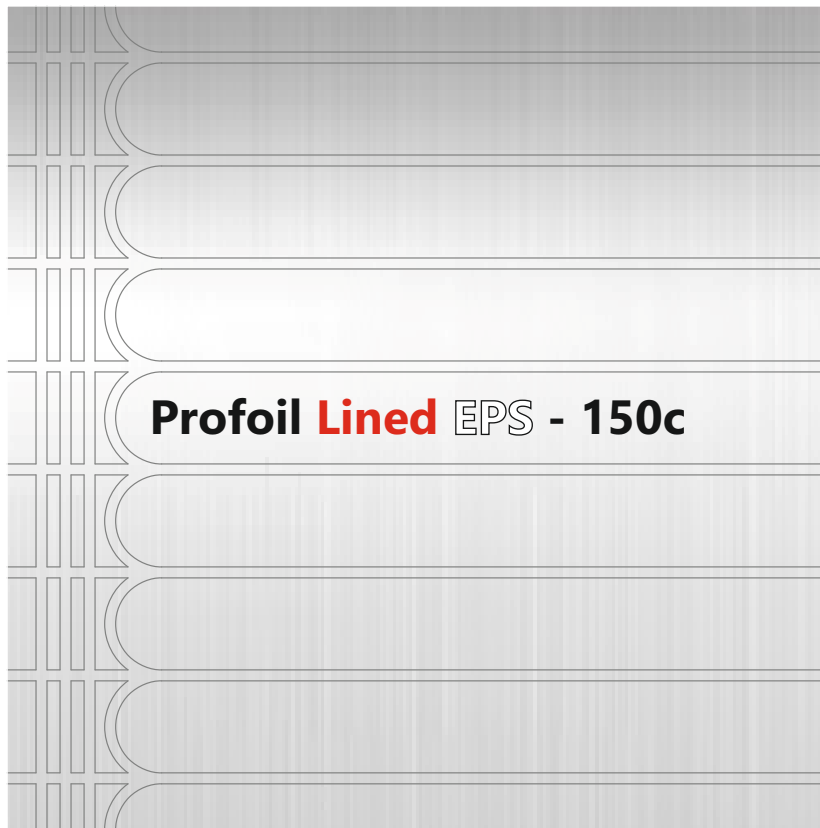

Profoil Lined EPS - 150c

Radius

150c also available
in Bulb pattern

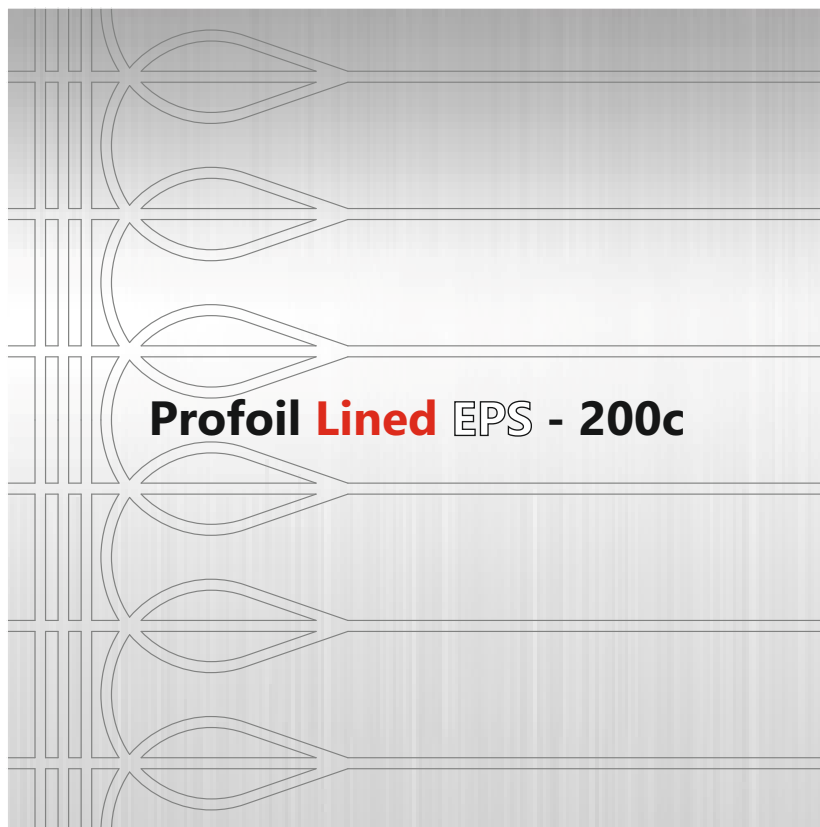

Profoil Lined EPS - 200c

Bulb

200c also available
in Radius pattern

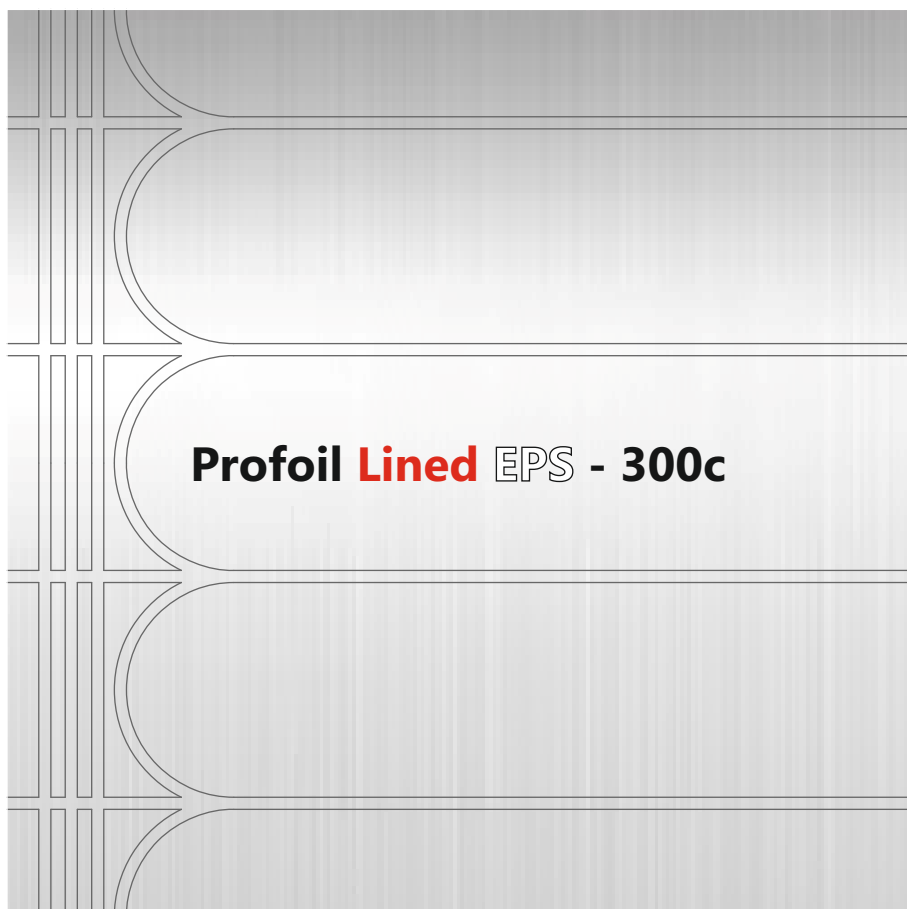

Profoil Lined EPS - 300c

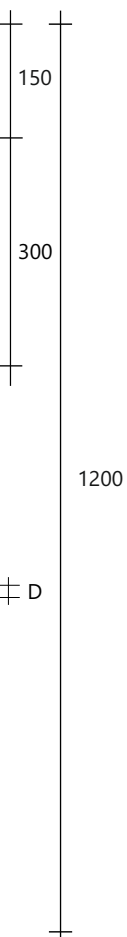

Radius

300c also available
in Bulb pattern



Profoil Lined EPS Highway

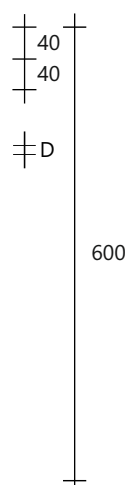

Highway

Flow and return panel,
used in association with
Radius & Bulb boards



Max
1200

Specials

Made to customers'
specific specification



Profoil® Sliced EPS 100

Foil faced and channels lined expanded polystyrene underfloor heating board

Technical specifications

Thickness' available - T	20, 25, 30, 40, 50, 60, 75mm ⁽¹⁾
Board sizes	600 x 1200mm & 1200 x 1200mm
Channel size (to suit UFH pipe diameter) - D	10, 12, 14 ⁽²⁾ , 15 ⁽²⁾ , 16 ⁽²⁾ mm
Pipe centre options	150, 200, 300mm
Thickness of aluminium foil facing	100, 200 ⁽¹⁾ µm (with foil pre-sliced)
Route patterns	Radius, Bulb, Highway ⁽³⁾
Strength at 10% compression (EN 826)	100kPa ⁽⁴⁾
Thermal conductivity (EN 13163)	0.036 W/mK
Associated polyethylene edge strip	EPIC Pro Edge

(1) Other thickness' manufactured to order, subject to minimum quantity. (2) Not available in 20mm thick boards.

(3) Other patterns manufactured to order, subject to minimum quantity. (4) 150 & 400kPa manufactured to order, subject to quantity.

Order quantity

Boards per pack	N/A
Min order qty	1 board

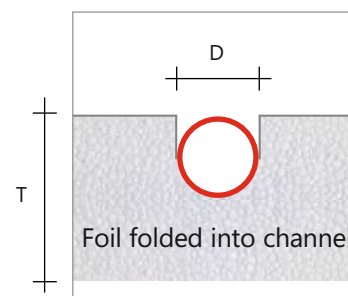

Profoil® Sliced EPS 200

Foil faced and channels lined high compressive strength polystyrene underfloor heating board

Technical specifications

Thickness' available - T	18, 25, 28, 30,mm ⁽¹⁾
Board sizes	600 x 1200mm & 1200 x 1200mm
Channel size (to suit UFH pipe diameter) - D	10, 12, 14, 15 ⁽²⁾ , 16 ⁽²⁾ mm
Pipe centre options - C	150, 200, 300mm
Thickness of aluminium foil facing	100, 200 ⁽³⁾ µm (with foil pre-sliced)
Route patterns	Radius, Bulb, Highway ⁽⁴⁾
Strength at 10% compression (EN 826)	200kPa
Thermal conductivity (EN 13163)	0.034 W/mK
Associated polyethylene edge strip	Epic Pro Edge

(1) Other thickness' manufactured to order, subject to minimum quantity. (2) Not available in 18mm thick boards.

(3) Manufactured to order, subject to minimum quantity. (4) Other patterns manufactured to order, subject to minimum quantity.

Order quantity

Boards per pack	N/A
Min order qty	1 board

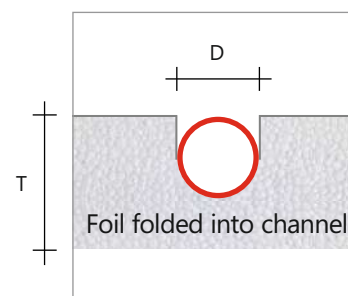



Profoil® Sliced EPS Channel Patterns

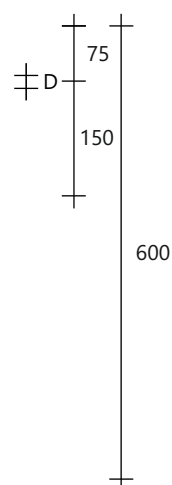
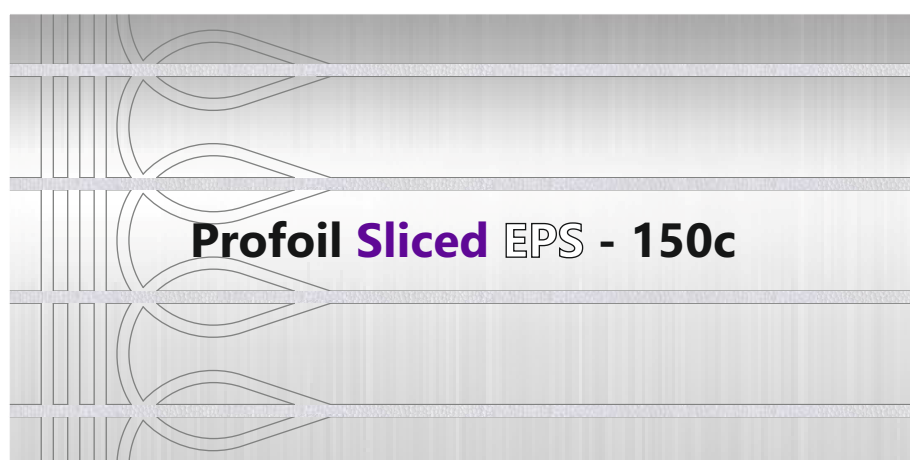

Bulb

150c also available
in Radius pattern

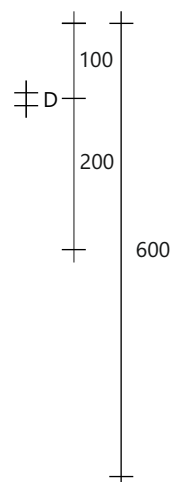
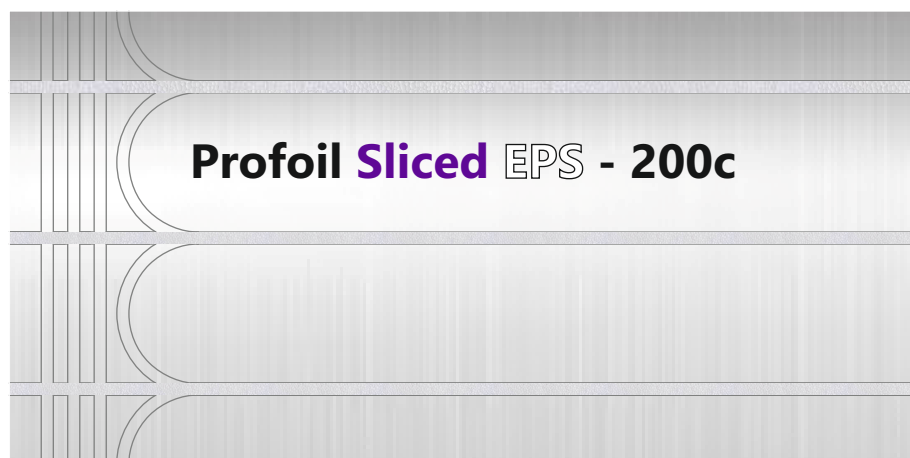

Radius

200c also available
in Bulb pattern

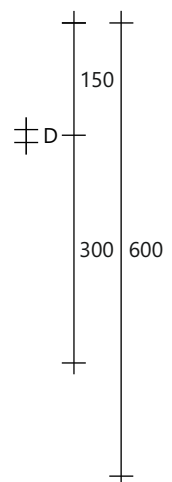

Bulb

300c also available
in Radius pattern

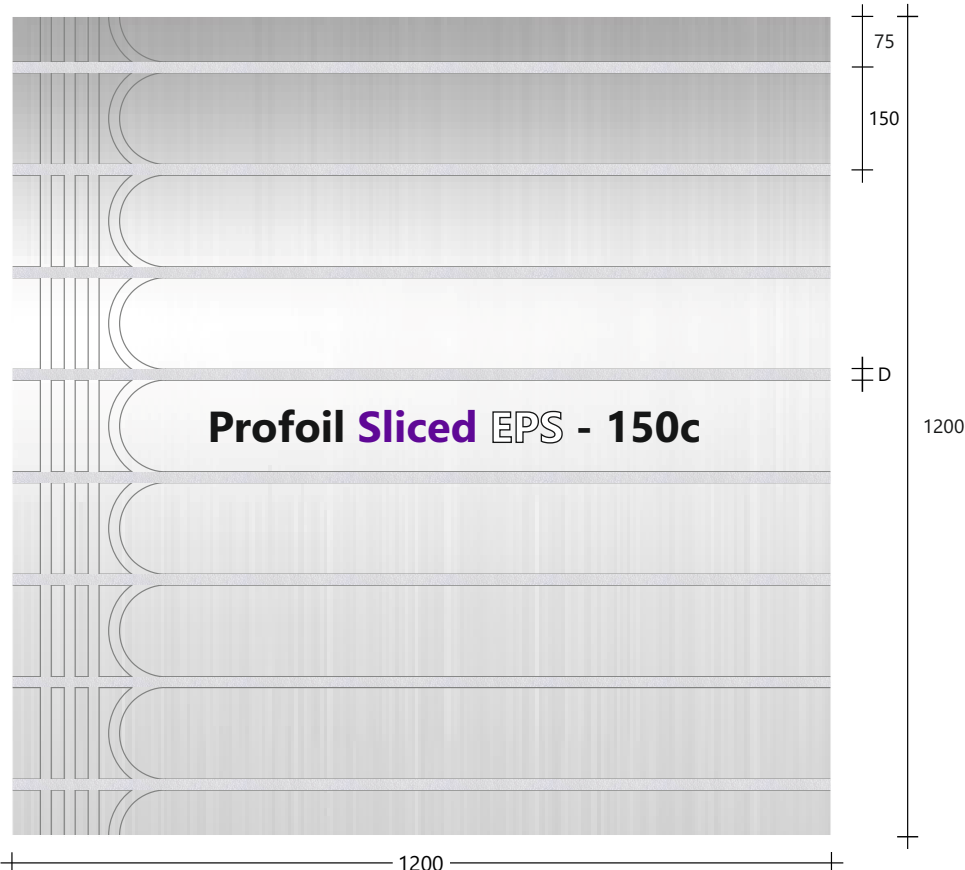

Radius

150c also available
in Bulb pattern

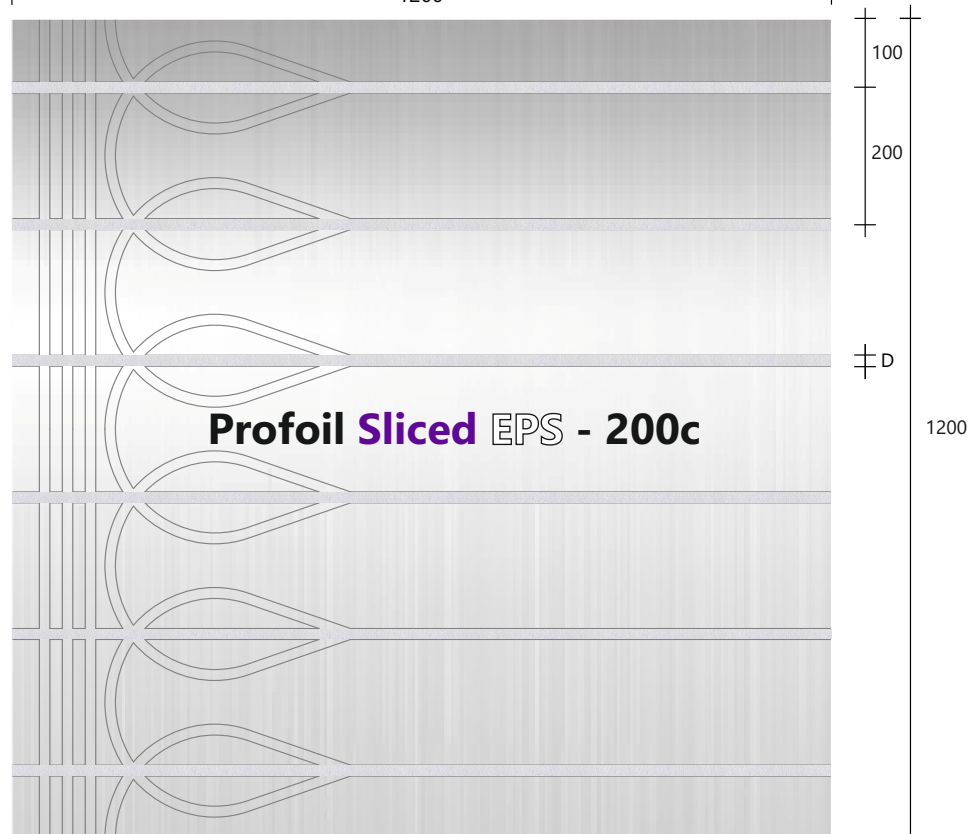

Bulb

200c also available
in Radius pattern



Profoil Sliced EPS - 300c

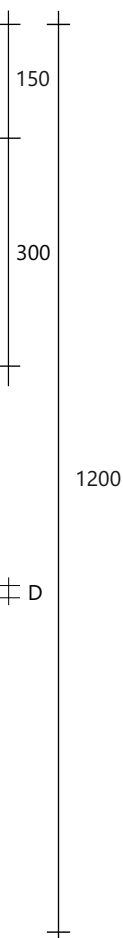

Radius

300c also available
in Bulb pattern



Profoil Sliced EPS - Highway

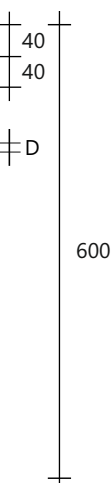

Highway

Flow and return panel,
used in association with
Radius & Bulb boards



Max
1200

Specials

Made to customers'
specific specification

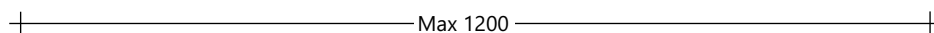



Profoil® Joist Lined EPS 100

Between joist / battens expanded polystyrene underfloor heating board

Technical specifications

Thickness' available - T	30 - 150mm ⁽¹⁾
Board sizes	350 x 1200
Route size (to suit UFH pipe diameter) - D	10, 12, 14, 15, 16mm
Pipe centre options	150, 200mm
Thickness of aluminium foil facing	100µm (with channels fully lined)
Route patterns	Radius, Bulb
Strength at 10% compression (EN 826)	100kPa
Thermal conductivity (EN 13163)	0.036W/mK
Associated polyethylene edge strip	EPIC Pro Edge

(1) Manufactured to order, subject to minimum quantity.

Order quantity

Boards per pack	N/A
Min order qty	Please call

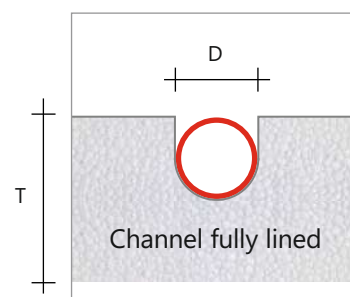

Profoil® Joist Lined EPS 200

Between joist / battens expanded polystyrene underfloor heating board

Technical specifications

Thickness' available - T	30 - 150mm ⁽¹⁾
Board sizes	350 x 1200
Channel size (to suit UFH pipe diameter) - D	10, 12, 14, 15, 16mm
Pipe centre options	150, 200mm
Thickness of aluminium foil facing	100µm (with channels fully lined)
Route patterns	Radius, Bulb
Strength at 10% compression (EN 826)	200kPa
Thermal conductivity (EN 13163)	0.034 W/mK
Associated polyethylene edge strip	Epic Pro Edge

(1) Manufactured to order, subject to minimum quantity.

Order quantity

Boards per pack	N/A
Min order qty	Please call

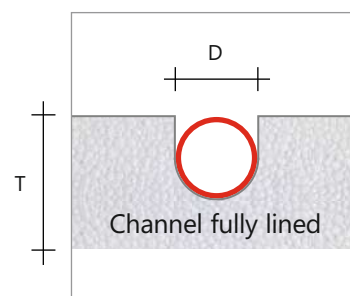



Profoil® Joist **Lined** EPS Channel Patterns

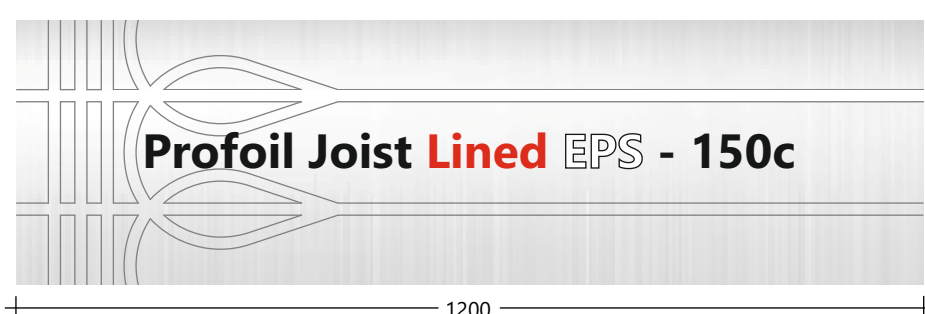

1200

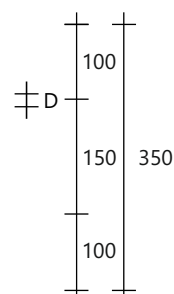

Bulb

150c also available
in Radius pattern



1200

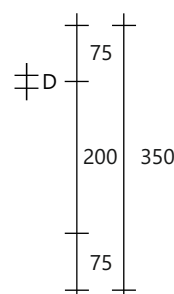

Radius

200c also available
in Bulb pattern

Progroove[®] EPS

Grooved expanded polystyrene underfloor heating board



- Offered in two grades of expanded polystyrene (100 & 200kPa)
- Works in conjunction with EPIC Proplates to deliver outstanding heat diffusion
- Wide range of thickness' available
- Two route patterns offered
- Suitable for all types of concrete & timber floors
- Quick and easy to install
- Excellent thermal performance



Designed & Manufactured in the UK



Progroove[®] EPS 100

Grooved expanded polystyrene underfloor heating board

Technical specifications

Thickness' available - T	20, 25, 30mm ⁽¹⁾
Board sizes	600 x 1200mm & 1200 x 1200mm
Channel size (to suit UFH pipe diameter) - D	10, 12, 14, 15, 16mm
Pipe centre options	150, 200, 300mm
Route patterns	Radius, Bulb, Highway, ⁽²⁾
Strength at 10% compression (EN 826)	100kPa ⁽³⁾
Thermal conductivity (EN 13163)	0.036 W/mK
Associated heat diffuser	EPIC Proplate - Single
Associated polyethylene edge strip	EPIC Pro Edge

(1) Other thickness' manufactured to order, subject to minimum quantity. (2) Other patterns manufactured to order, subject to minimum quantity.

(3) 150 & 400kPa manufactured to order, subject to quantity.

Order quantity

Boards per pack	N/A
Min order qty	1 board

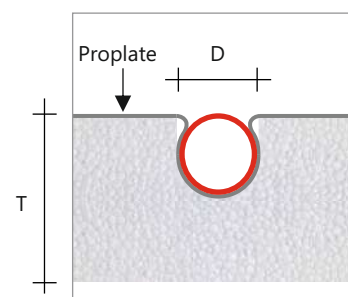

Note. EPIC Proplate sold separately

Progroove[®] EPS 200

Grooved high compressive strength expanded polystyrene underfloor heating board

Technical specifications

Thickness' available - T	18, 25, 28, 30,mm ⁽¹⁾
Board sizes	600 x 1200mm & 1200 x 1200mm
Channel size (to suit UFH pipe diameter) - D	10, 12, 14 ⁽²⁾ , 15 ⁽²⁾ , 16 ⁽²⁾ mm
Pipe centre options	150, 200, 300mm
Route patterns	Radius, Bulb, Highway, Special ⁽³⁾
Strength at 10% compression (EN 826)	200kPa
Thermal conductivity (EN 13163)	0.034 W/mK
Associated heat diffuser required	EPIC Proplate - Single
Associated polyethylene edge strip	EPIC Pro Edge

(1) Other thickness' manufactured to order, subject to minimum quantity. (2) Not available in 18mm thick boards.

(3) Other patterns manufactured to order, subject to minimum quantity.

Order quantity

Boards per pack	N/A
Min order qty	1 board

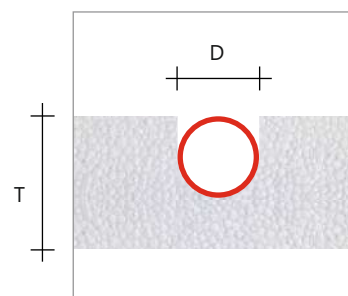

Note. EPIC Proplate required



Progroove® EPS Channel Patterns



Progroove EPS - 150c

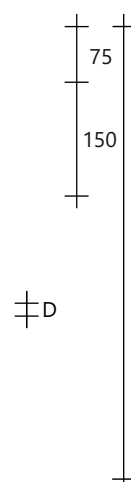

Bulb

150c also available
in Radius pattern



Progroove EPS - 200c

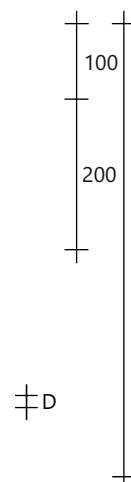

Radius

200c also available
in Bulb pattern

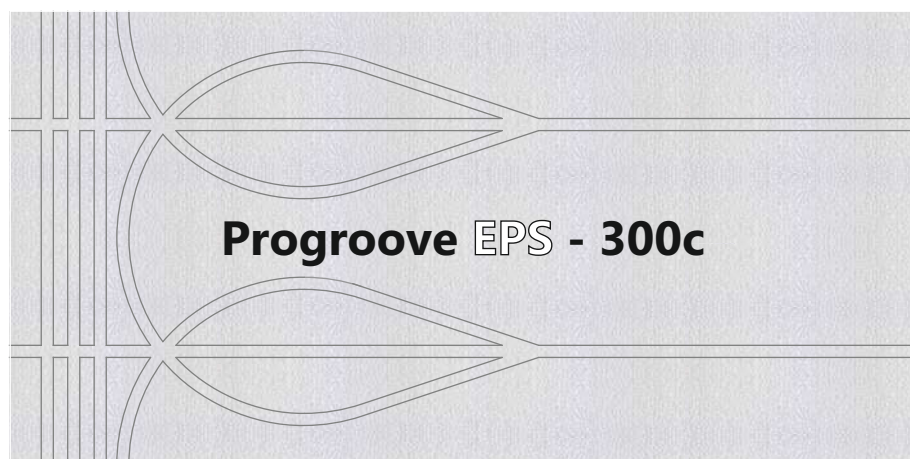

Progroove EPS - 300c

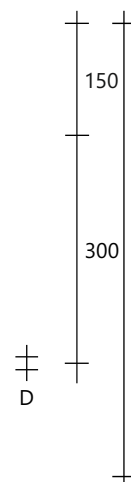

Bulb

300c also available
in Radius pattern

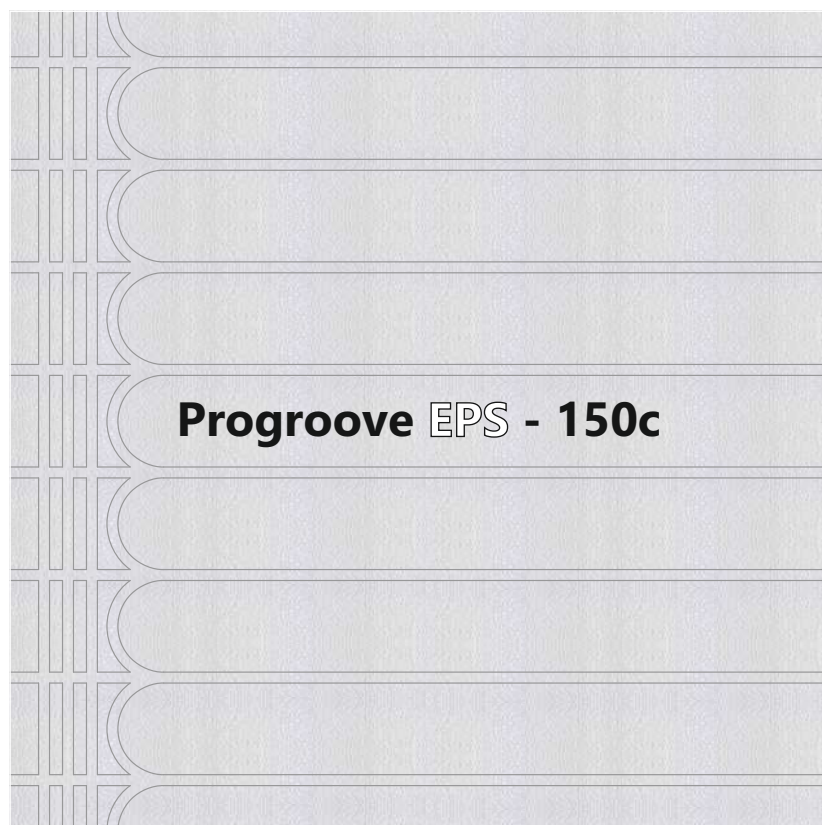

Progroove EPS - 150c

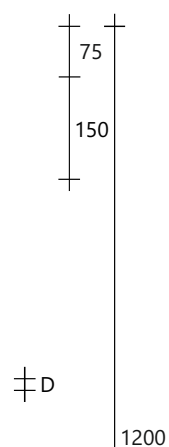

Radius

150c also available
in Bulb pattern

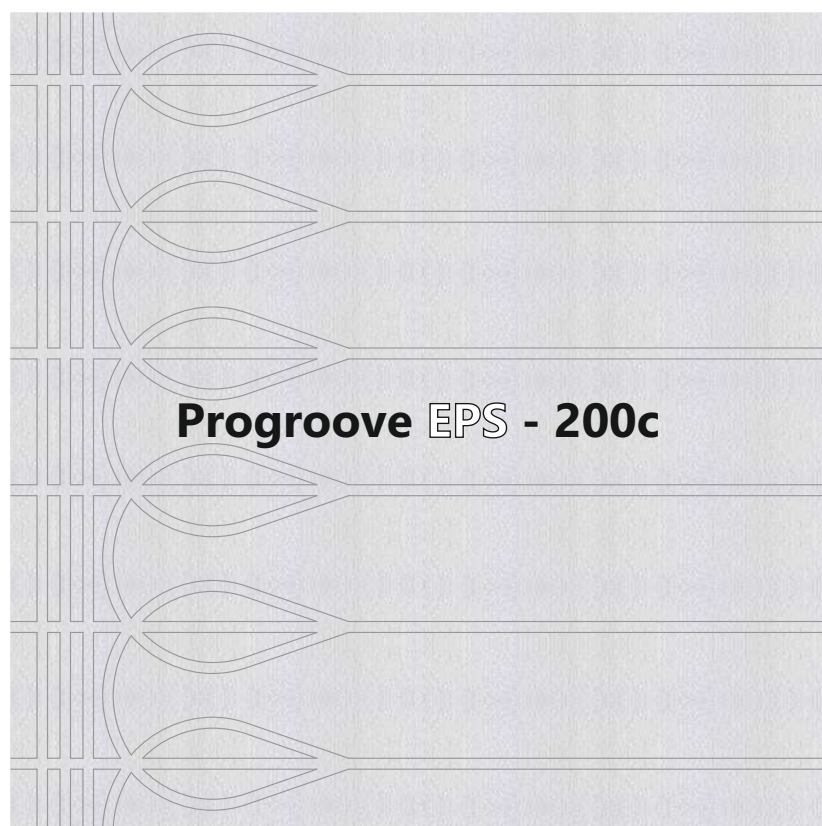

Progroove EPS - 200c

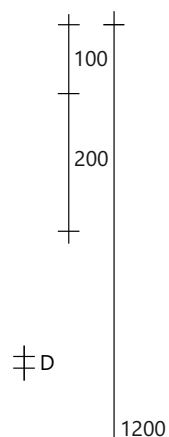

Bulb

200c also available
in Radius pattern

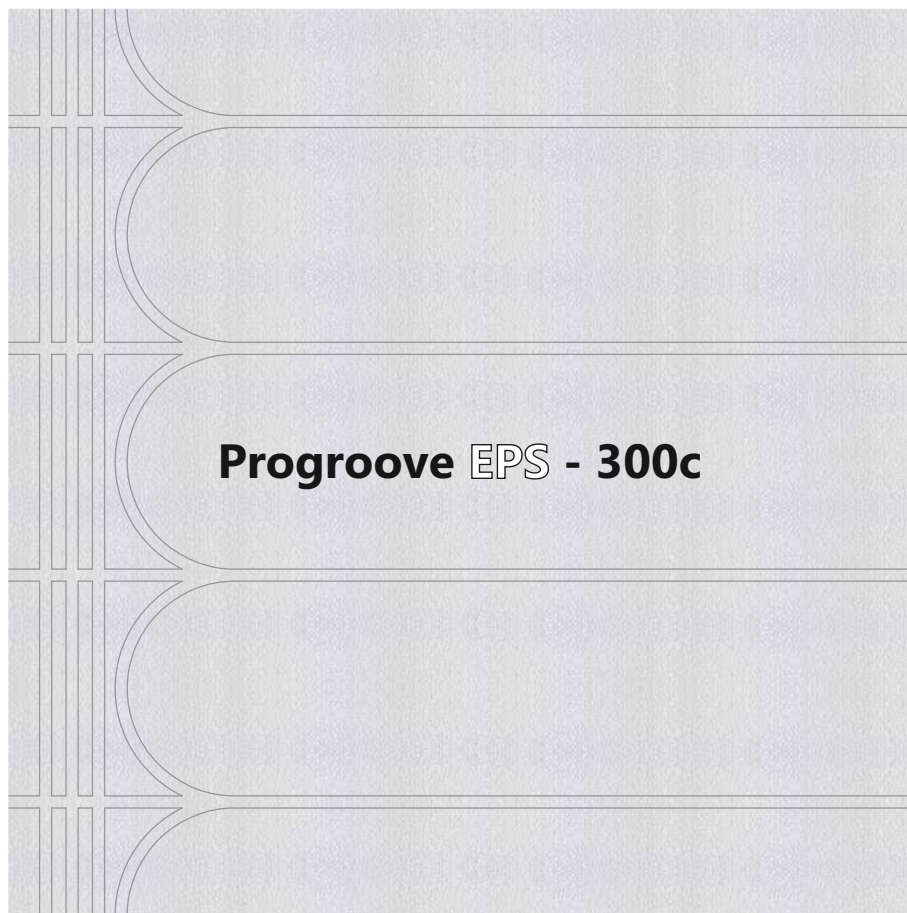

Progroove EPS - 300c

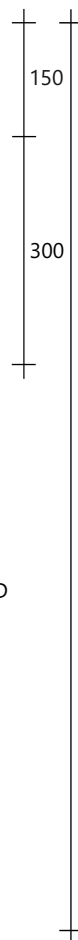

Radius

300c also available
in Bulb pattern

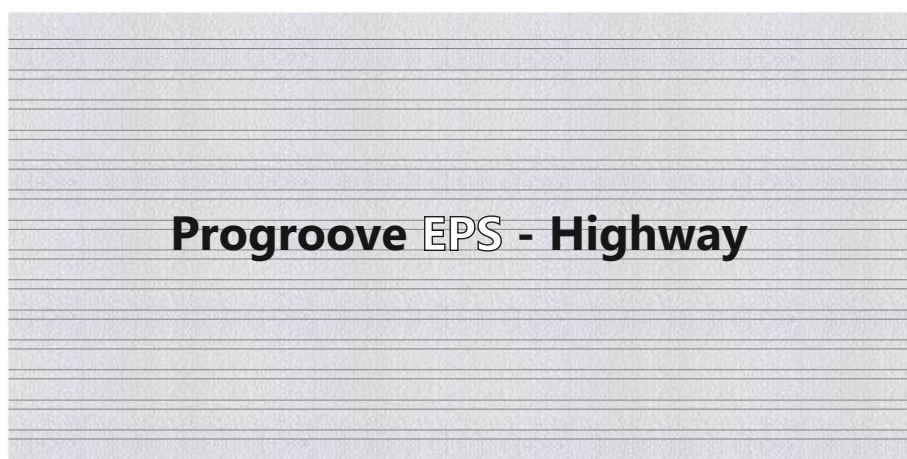

Progroove EPS - Highway

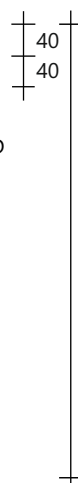

Highway

Flow and return panel,
used in association with
Radius & Bulb boards



Max
1200

Specials

Made to customers'
specific specification

Max 1200



Profoil® Joist **Lined** EPS Channel Patterns

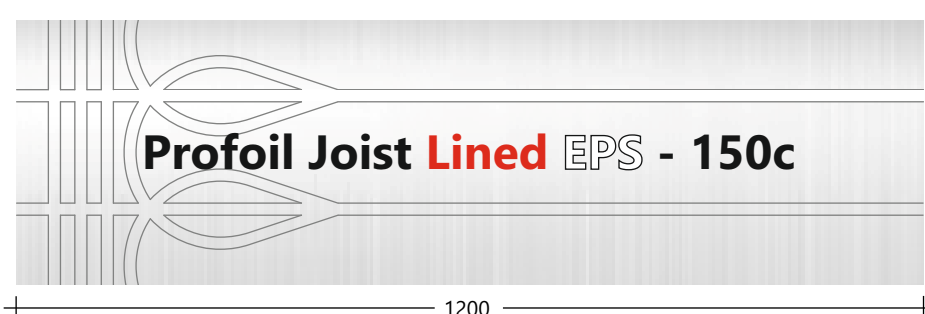

1200

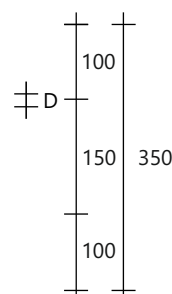

Bulb

150c also available
in Radius pattern



1200

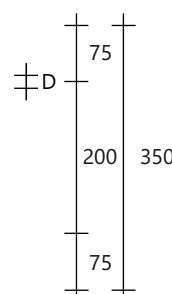

Radius

200c also available
in Bulb pattern



Progroove[®] Joist EPS 100

Grooved between joist / battens expanded polystyrene underfloor heating board

Technical specifications

Thickness' available - T	30 - 150mm ⁽¹⁾
Board sizes	350 x 1200
Route size (to suit UFH pipe diameter) - D	10, 12, 14, 15, 16mm
Pipe centre options	150, 200mm
Route patterns	Radius, Bulb
Strength at 10% compression (EN 826)	100kPa
Thermal conductivity (EN 13163)	0.036 W/mK
Associated heat diffuser required	EPIC Proplate - Double or Triple
Associated polyethylene edge strip	EPIC Pro Edge

(1) Manufactured to order, subject to minimum quantity.

Order quantity

Boards per pack	N/A
Min order qty	Please call

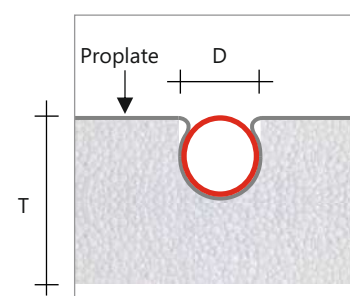

Note. EPIC Proplate sold separately

Progroove[®] Joist EPS 200

Grooved between joist / battens high strength expanded polystyrene underfloor heating board

Technical specifications

Thickness' available - T	30 - 150mm ⁽¹⁾
Board sizes	350 x 1200
Route size (to suit UFH pipe diameter) - D	10, 12, 14, 15, 16mm
Pipe centre options	150, 200mm
Route patterns	Radius, Bulb
Strength at 10% compression (EN 826)	200kPa
Thermal conductivity (EN 13136)	0.034 W/mK
Associated heat diffuser required	Epic Proplate - Double or Triple
Associated polyethylene edge strip	Epic Pro Edge

(1) Manufactured to order, subject to minimum quantity.

Order quantity

Boards per pack	N/A
Min order qty	Please call

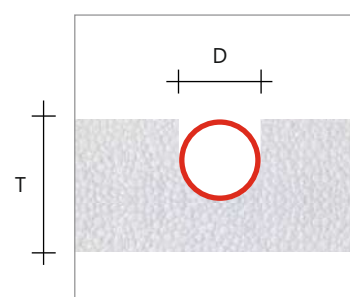

Note. EPIC Proplate required



Progroove® Joist EPS Channel Patterns

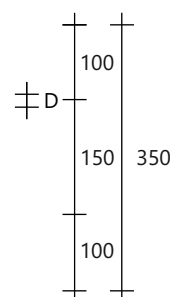
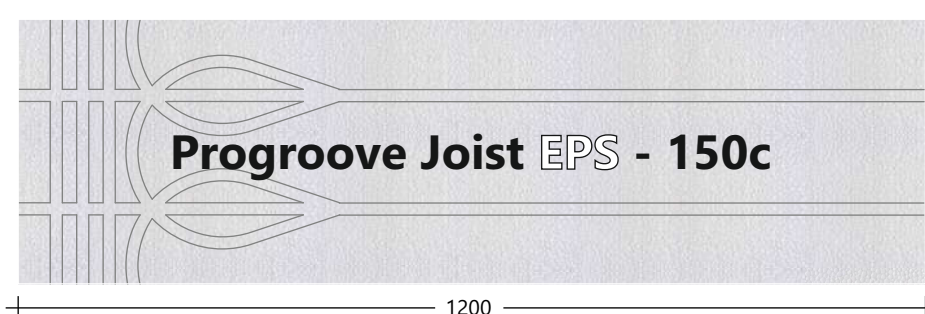

Bulb

150c also available
in Radius pattern

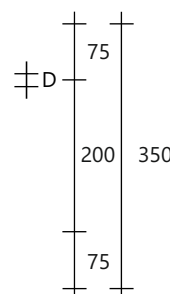
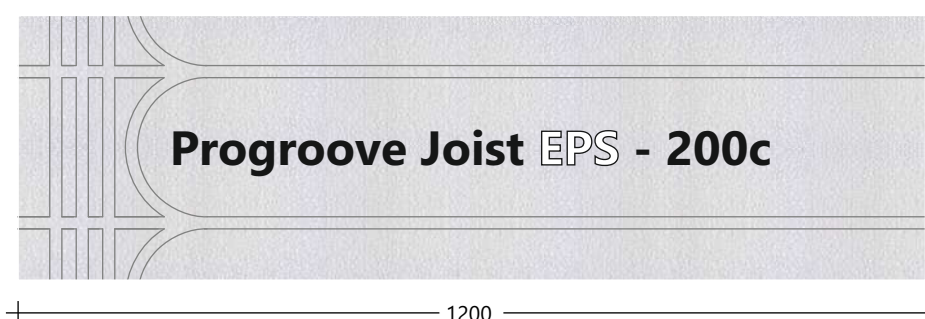

Radius

200c also available
in Bulb pattern

Associated accessories

**EPIC Proplate
Double 150 & 200c**
Aluminium heat diffusers



(P. 52)

EPIC Edge 75/AB
Self-adhesive perimeter
edge roll



(P. 53)



Protile[®]

Reinforced cementitious fibre faced high compressive strength extruded polystyrene underfloor heating board

Technical specifications

Thickness' available - T	20mm ⁽¹⁾
Board sizes	600 x 1200mm & 600 x 600mm*
Route size (to suit UFH pipe diameter) - D	10, 12, 14, 15, 16mm
Pipe centre option	150, 200, 300mm
Route patterns	Radius, Bulb, Highway & 90 Degree*
Strength at 10% compression (EN 826)	300kPa
Thermal conductivity (EN 12667)	0.033W/mK
Associated adhesive to bond board to floor	EPIC HB24
Associated polyethylene edge strip	EPIC Pro Edge

(1) Other thickness' manufactured to order, subject to minimum quantity.

Order quantity

Boards per pack	N/A
Min order qty	1 board

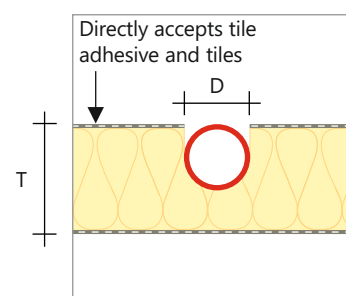

Associated accessories

EPIC Edge 75/AB

Self-adhesive perimeter edge roll



(P. 53)

EPIC HB24

High bond floor adhesive



(P. 54)



Protile® Channel Patterns

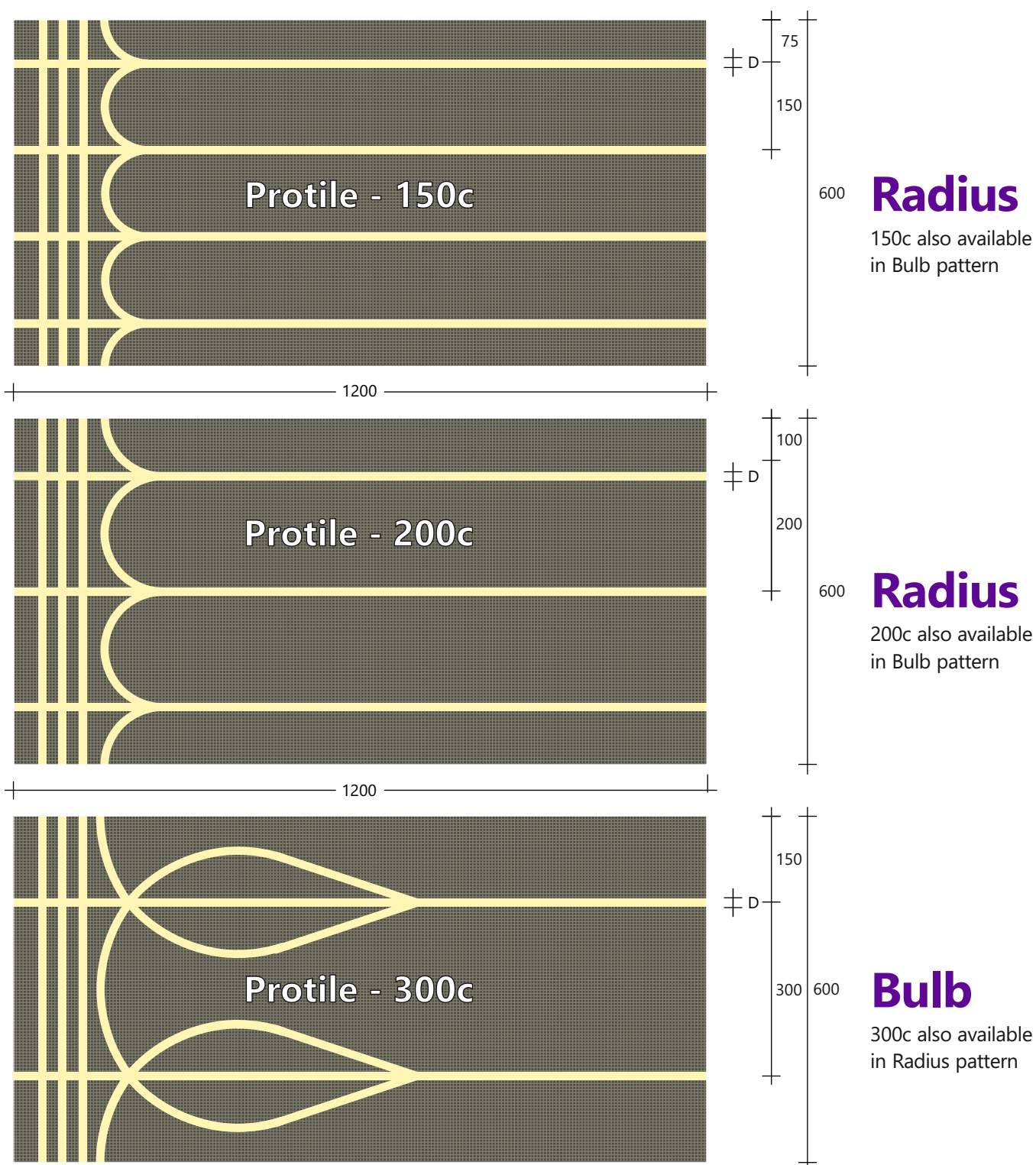



Protile® Channel Patterns

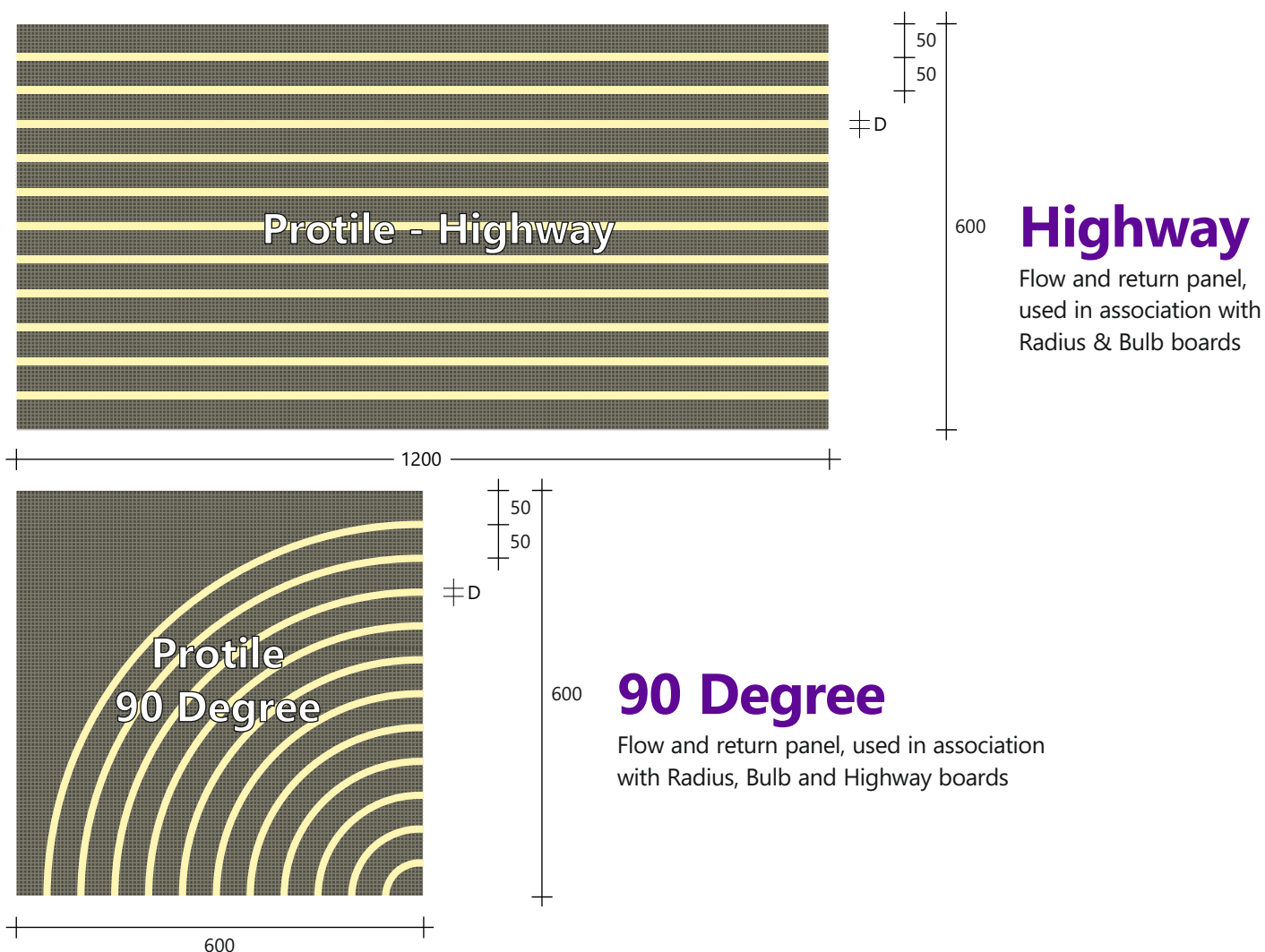



Prochip

Structural underfloor heating floorboard

Technical specifications

Thickness available - T	22mm
Board sizes	600 x 2400mm
Route size (to suit UFH pipe diameter) - D	10, 12mm (+0.4)
Pipe centre options	150, 200mm
Route patterns	Radius, Straights ⁽¹⁾
Associated conductive topping board	CEMDECK®+
Associated polyethylene edge strip	EPIC Pro Edge

(1) Other patterns manufactured to order, subject to minimum quantity.

Order quantity

Coverage per panel	1.44m ²
Pallet qty	60 boards
Min order qty	1 board

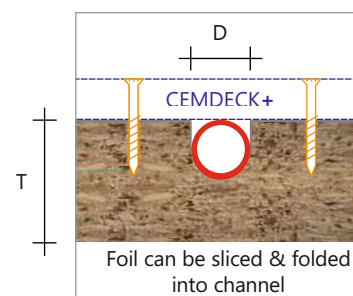

Associated accessories

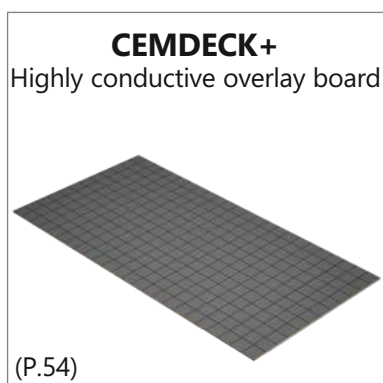



Radius
(Other patterns
manufactured
subject to quantity)





insulation and ufh systems

01923 725180

Quick call



| 75 | | 150 | | 150 | | 150 | | 75 |



Prochip
150c

2400

Straights

| 100 | | 200 | | 200 | | 100 |



Prochip
200c

2400



Prochip FF

Foil Faced Structural underfloor heating floorboard

Technical specifications

Thickness' available - T	22mm
Board sizes	600 x 2400mm
Route size (to suit UFH pipe diameter) - D	10, 12mm (+0.4)
Pipe centre options	150, 200mm
Thickness of aluminium foil facing	50µm, 100µm(with foil ready to slice)
Route patterns	Radius, Straights ⁽¹⁾
Associated conductive overlay board	CEMDECK®+
Associated polyethylene edge strip	EPIC Pro Edge

(1) Other patterns manufactured to order, subject to minimum quantity.

Order quantity

Coverage per panel	1.44m ²
Pallet qty	60 boards
Min order qty	1 board

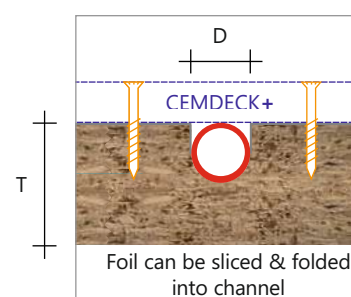

Associated accessories

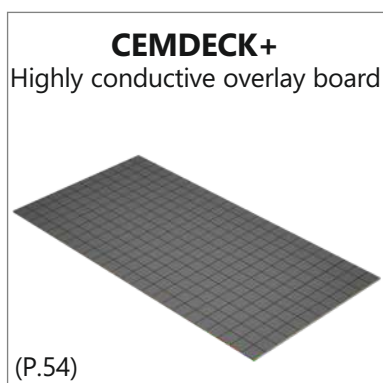

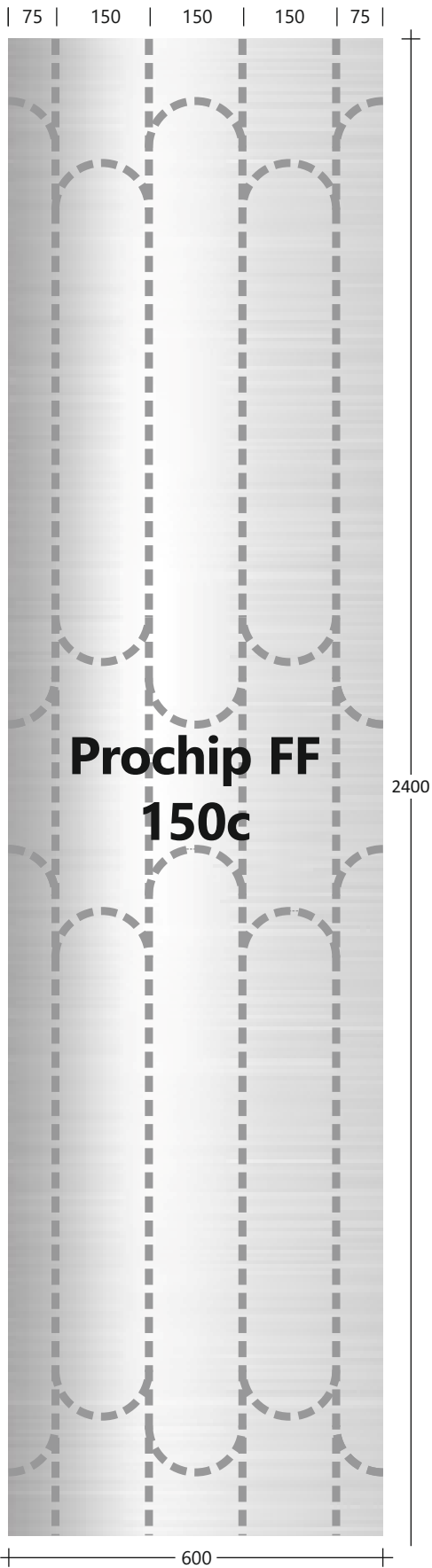

**Prochip FF
150c**

Radius
(Other patterns
manufactured
subject to quantity)

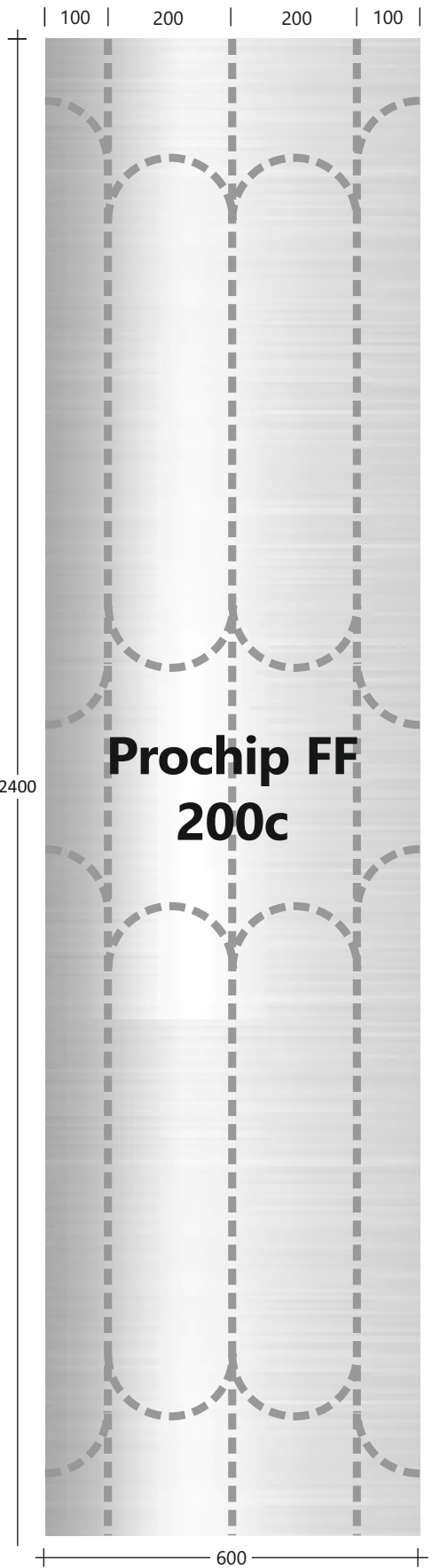

**Prochip FF
200c**



Own branded UFH boards

Epic offers the option of customers having their company / brand name printed on the routed XPS & EPS insulation boards in one of three colours. Contact the sales office for full specification and minimum order quantities requirements.

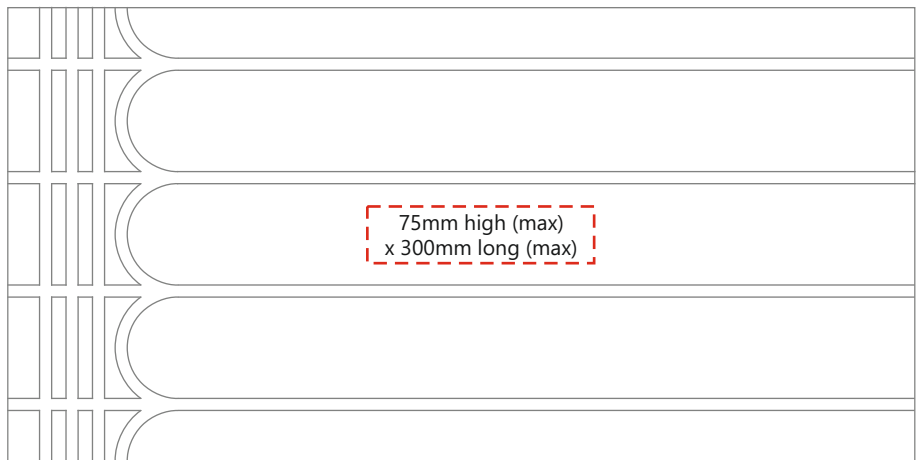

Print colour options

- Red
- Black
- Blue

Minimum order quantity

Please contact the sales office

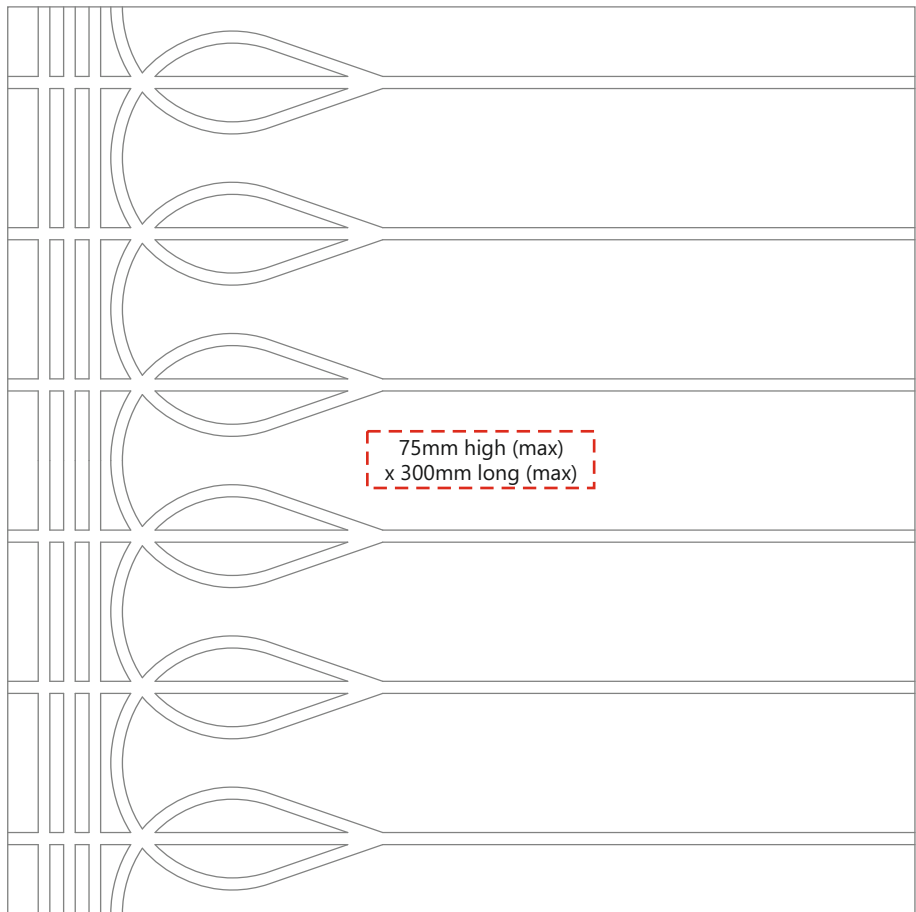

Proplate

Aluminium heat diffusion plates

Technical specifications

Aluminum thickness	0.5mm
Plate length	1000mm
Single channel impression plate width	150mm ⁽¹⁾
Double channel impressions plate width	390mm ⁽¹⁾ (150 & 200mm centres)
Triple channel impressions plate width	390mm ⁽¹⁾ (150mm centres)
Channel impression size - D	10, 12, 14, 15, 16
Associated insulation boards	Progroove / Progroove joist XPS, EPS
Associated polyethylene edge strip	Epic Pro Edge

(1) Other widths and centres manufactured to order, subject to quantity.

Order quantity	Plates per box
Single	120
Double	50
Triple	40
Min order qty	1 box

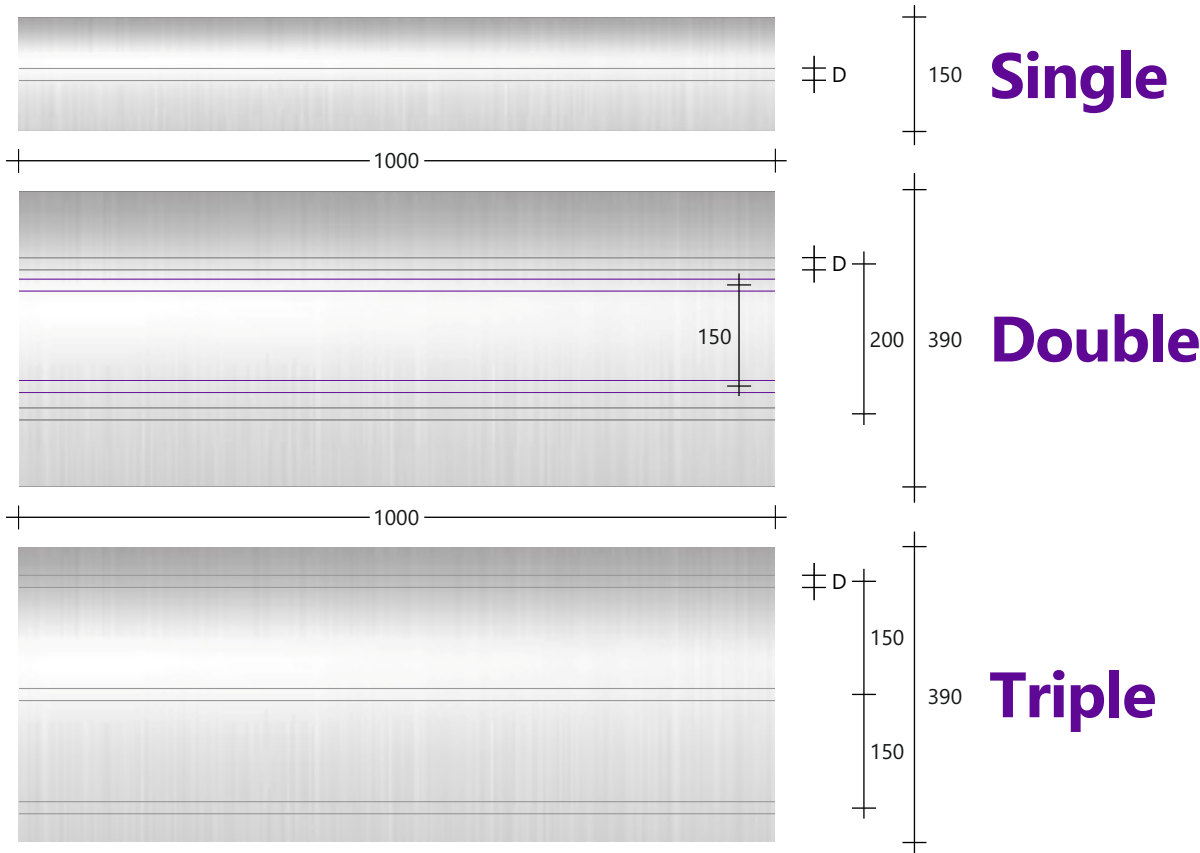
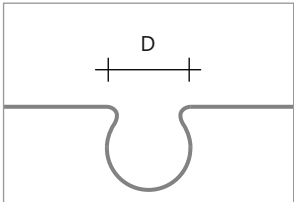



EPIC Edge

Polyethylene perimeter edge foam rolls

Technical specifications



	EPIC Edge 75/AB	EPIC Edge 100	EPIC Edge 150	EPIC Edge 200
				
Thickness	5mm	5mm	5mm	5mm
Roll height	75mm	100mm	150mm	200mm
Roll length	50m	50m	50m	50m
Self adhesive backing	Yes	-	-	-
Quantity per pack	16	12	8	6
Minimum order qty	1 roll	1 roll	1 roll	1 roll

(1) Other thickness, heights and roll lengths manufactured to order, subject to minimum quantity.

EPIC Highway Clip Rail

Polypropylene clip rail for Profix

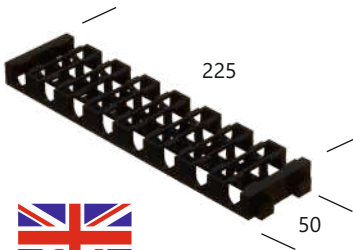
Technical specifications

Composition	100% recycled, high impact polypropylene	  Designed & Manufactured in the UK
Application	Pipe retainer to elevate the pipe, allowing the screed to flow underneath and cover the pipe completely	
Qty of pipe retention clips	8 per rail	
Pipe size suitability	10, 12mm	
Rails per box	10	
Minimum order qty	1 Box	



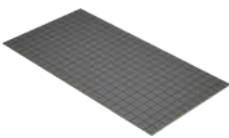

Highly Conductive Overlay Boards

Technical specifications

	HiDECK® 18 Overlay	CEMDECK®+
		
Composition	High density gypsum reinforced with cellulose	Cementitious faced Class 2 plywood with install grid
Application	T&G overlay board for Profix , Profoil & Progroove	Overlay board for Prochip
Dimensions	18 x 600 x 1200mm	5.6 x 600 x 1200mm
Thermal resistance	0.045m²K/W	0.043m²K/W
Weight	15.55kg per board	5.20kg per board
Boards per pallet	66	N/A
Minimum order qty	1 Board	1 Board

EPIC Adhesives

Technical specifications

	EPIC Pro Adhesive (MCPU)	EPIC PVA Adhesive	EPIC HB24 Adhesive
			
Application	Bonding HiDECK Overlay T & G Edges	Bonding Prochip T & G Edges	Bonding insulation boards to subfloor
Bottle size	1kg	1kg	15kg
Typical coverage	33m²	33m²	46m²
Curing time	24 hours	24 hours	1 hour high grab 24 hours full bond
Minimum order	1 bottle	1 bottle	1 tub

Further Information

EPIC Insulation manufactures its products under ISO 9001 and 14001 management controls. Where possible, they are made from recycled materials and are recyclable.

Packaging

EPIC underfloor heating products are packed or palletised in such a way that they arrive on site in pristine condition.

On-site handling & storage

EPIC XPS and EPS boards can be stored outside. However, they should be protected from long-term exposure to direct sunlight, otherwise surface degradation may occur.

Installation instructions

For detailed installation instructions and advice contact EPIC's technical team on 01923 725180 or email sales@epicinsulation.co.uk

Health and safety

Copies of safety data sheets for all EPIC products are available upon request.

UK & CE marking

EPIC XPS and EPS boards are manufactured in accordance with both UKCA and CE requirements

Fire classification

Where possible EPIC's insulation boards contain fire retardant additives to inhibit accidental ignition. However, plastic foams and wood are combustible and may burn rapidly if exposed to intense fire.

Profoil®, **Progroove**® and **Protile**® XPS and EPS - Euroclass E*

HiDECK® **18 Overlay** - Euroclass A1 (non-combustible, when tested in accordance with BS EN 13501-1: 2007 +A1: 2009)

Notes

Epic Insulation Limited reserves the right to amend product specifications without prior notice. Colours shown are for illustration purposes. Product technical data stated is typical. The information included in this technical manual is based on Epic's experience and is believed to be reliable.

Epic Insulation Limited as the manufacturer, has no control over the installation of its products. The purchaser should evaluate the product's suitability and is responsible for adhering to any laws or regulations in this respect, making the purchaser also liable for observing any third party rights.

Profix®, **Profoil**®, **Progroove**® and **Protile**® are registered Trademarks of Epic Insulation Limited.

EPIC
insulation and ufh systems

01923 725180
sales@epicinsulation.co.uk
www.epicinsulation.co.uk